



**ARLINGTON COUNTY, VIRGINIA**  
 DEPARTMENT OF ENVIRONMENTAL SERVICES  
 ENGINEERING AND CAPITAL PROJECTS DIVISION  
 SURVEY SECTION

#1 COURTHOUSE PLAZA, SUITE 813  
 2100 CLARENDON BOULEVARD  
 ARLINGTON, VIRGINIA 22201  
 (703) 228-3686 · FAX (703) 228-3606



**GEODETTIC CONTROL SHEET**

STATION ID #: CP-119

STATION NAME: V20

DATUM: NAD 83 (2007)	MAP PROJECTION: Lambert	CONVERSION: US Survey Foot	YEAR: 2009
N: 6,996,356.431	E: 11,876,978.094	Lat: 38° 51' 07.742" N	Lon: 77° 06' 58.435" W
GRID FACTOR: 0.99999341	SCALE FACTOR: 0.99995675	COMBINED FACTOR: 0.99995016	
VERTICAL DATUM: NAVD 88	CONV. ANGLE: +00° 51' 49.08"		
ELEV. (FT): 242.68 ±2cm	VERT. ORDER: GPS	HORIZONTAL ORDER: SECOND	

**TO REACH:**

The point is located in the grass strip along the north side of 10th Place S. The point is located 9.60' from a water meter for house #5223 and 8.30 from the corner of a brick column for #5223 with a mailbox installed.  
 The point is a standard Arlington County 3 1/2" brass disk set on a 600mm Brentsen Feno spike driven flush with the existing grade.

**SKETCH: NOT TO SCALE**

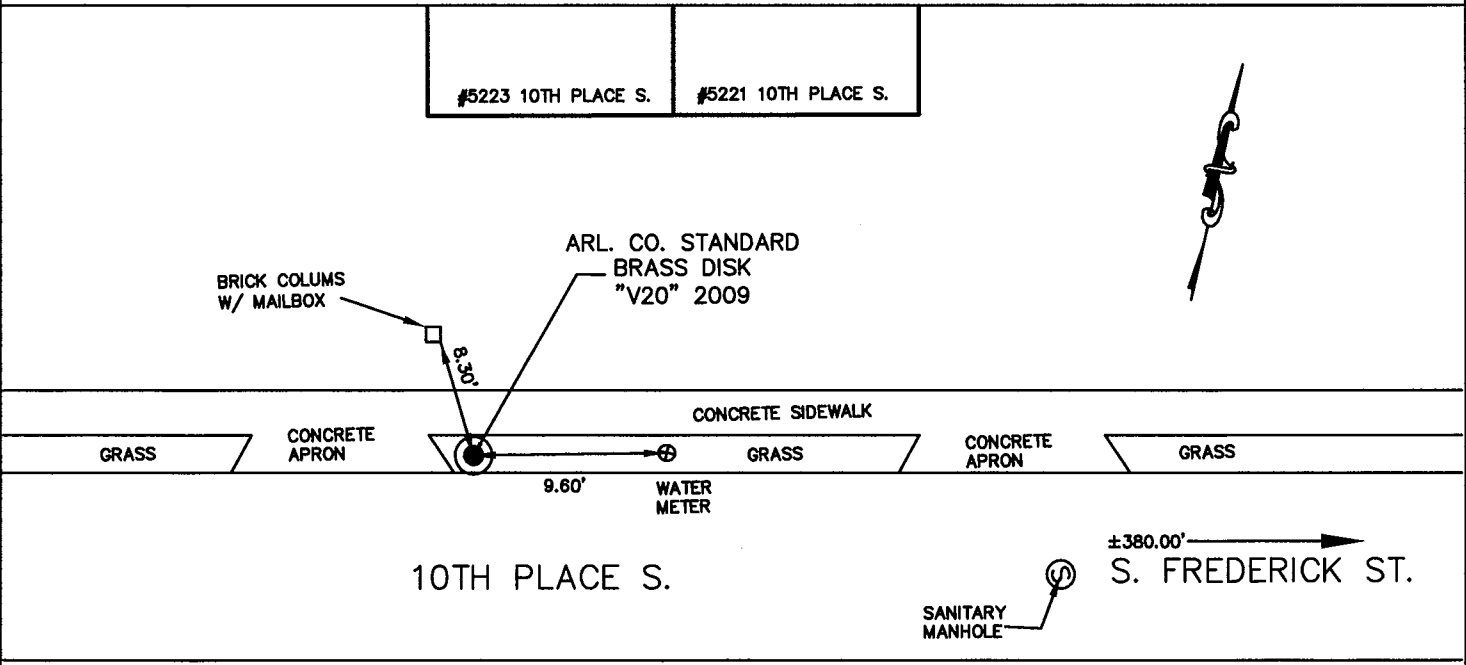

#5222 10TH PLACE S.