



# ARLINGTON COUNTY, VIRGINIA

DEPARTMENT OF PUBLIC WORKS  
ENGINEERING DIVISION  
SURVEY SECTION

#1 COURTHOUSE PLAZA, SUITE 813  
2100 CLARENDON BOULEVARD  
ARLINGTON, VIRGINIA 22201  
(703) 228-3686 · FAX (703) 228-3606



R. S. KEM  
DIRECTOR OF PUBLIC WORKS

## GEODETIC CONTROL SHEET

ADJACENT TO  
COURT HOUSE  
METRO STATION

DENNIS JOHNSON  
DIVISION CHIEF

STATION ID #:

STATION NAME: PHRA26

DATUM: NAD 83 (93)	MAP PROJECTION: Lambert	CONVERSION: US Survey Foot	YEAR: 2004
N: 7,009,468.768	E: 11,888,055.301	Lat: 38° 53'15.6642"N	Lon: 77° 04'35.8542"W
GRID FACTOR: 0.99995947	SCALE FACTOR: 0.99999137	COMBINED FACTOR: 0.99995084	
VERTICAL DATUM: NAVD 88	CONV. ANGLE: 00° 53' 18.1"	REVISION DATE: JANUARY 14, 2020	
ELEV. (FT): 180.91	VERTICAL ORDER: Third	HORIZONTAL ORDER: Second	

### TO REACH:

The point is located in the grass area at the intersection of North Queen Street and 12th Street North.  
The point is a standard Arlington County brass disk set in concrete.

### SKETCH: NOT TO SCALE

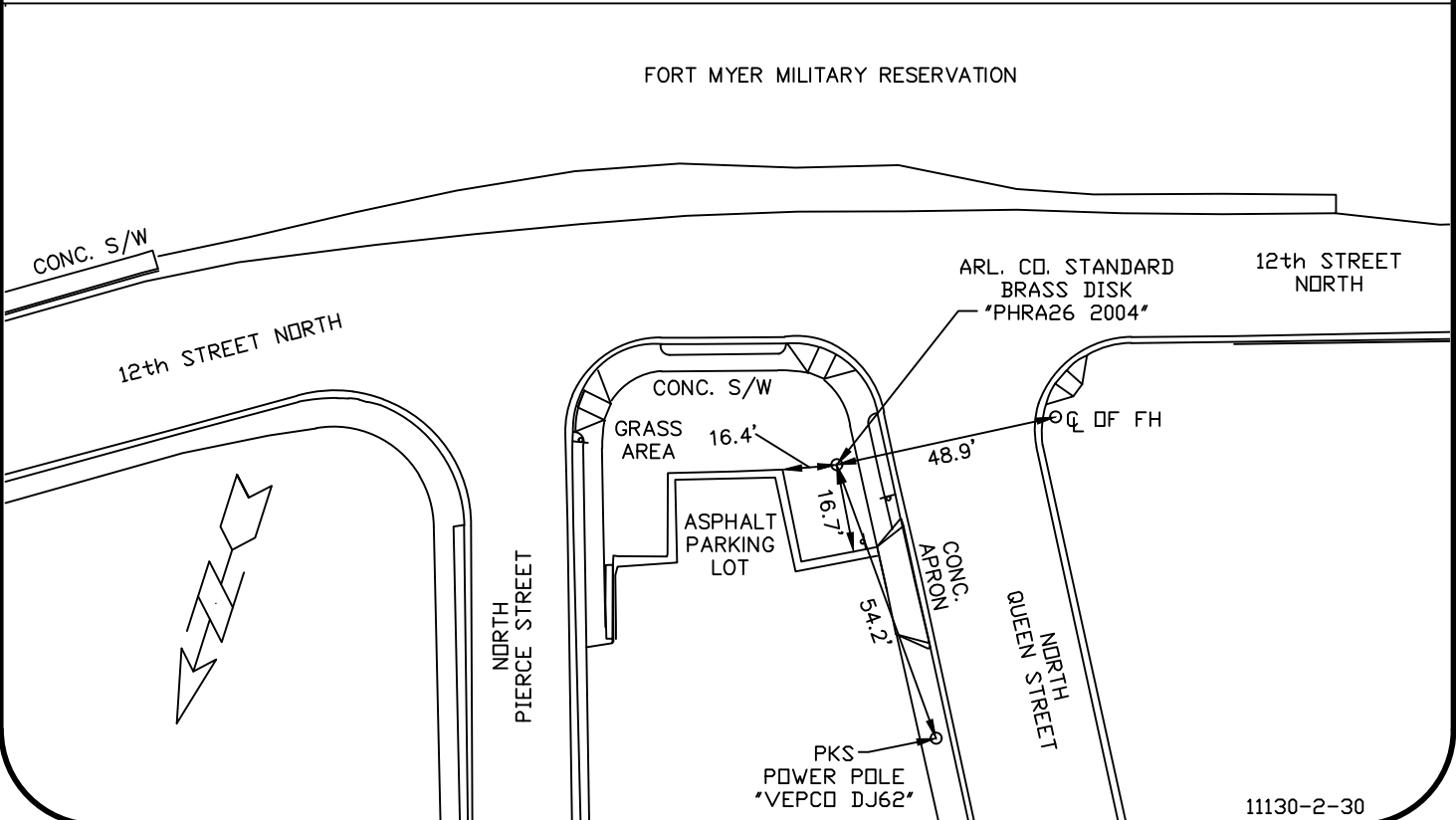

11130-2-30