



ARLINGTON COUNTY, VIRGINIA

DEPARTMENT OF PUBLIC WORKS
ENGINEERING DIVISION
SURVEY SECTION

#1 COURTHOUSE PLAZA, SUITE 813
2100 CLARENDON BOULEVARD
ARLINGTON, VIRGINIA 22201
(703) 228-3686 · FAX (703) 228-3606



R. S. KEM
DIRECTOR OF PUBLIC WORKS

GEODETIC CONTROL SHEET

ADJACENT TO
COURT HOUSE
METRO STATION

DENNIS JOHNSON
DIVISION CHIEF

STATION ID #:

STATION NAME: PHRA22

DATUM: NAD 83 (93)	MAP PROJECTION: Lambert	CONVERSION: US Survey Foot	YEAR: 2003
N: 7,013,272.623	E: 11,875,291.592	Lat: 38° 53'55.1849"N	Lon: 77° 07'16.5409"W
GRID FACTOR: 0.99996039	SCALE FACTOR: 0.99998081	COMBINED FACTOR: 0.99994120	
VERTICAL DATUM: NAVD 88	CONV. ANGLE: 00° 51' 37.8"	REVISION DATE: JULY 2, 2020	
ELEV. (FT): 401.85'	VERTICAL ORDER: Third	HORIZONTAL ORDER: Second	

TO REACH:

The point is located in the grass median at the intersection of Old Dominion Drive and North Abingdon Street.
The point is a standard Arlington County brass disk set in concrete.

SKETCH: NOT TO SCALE

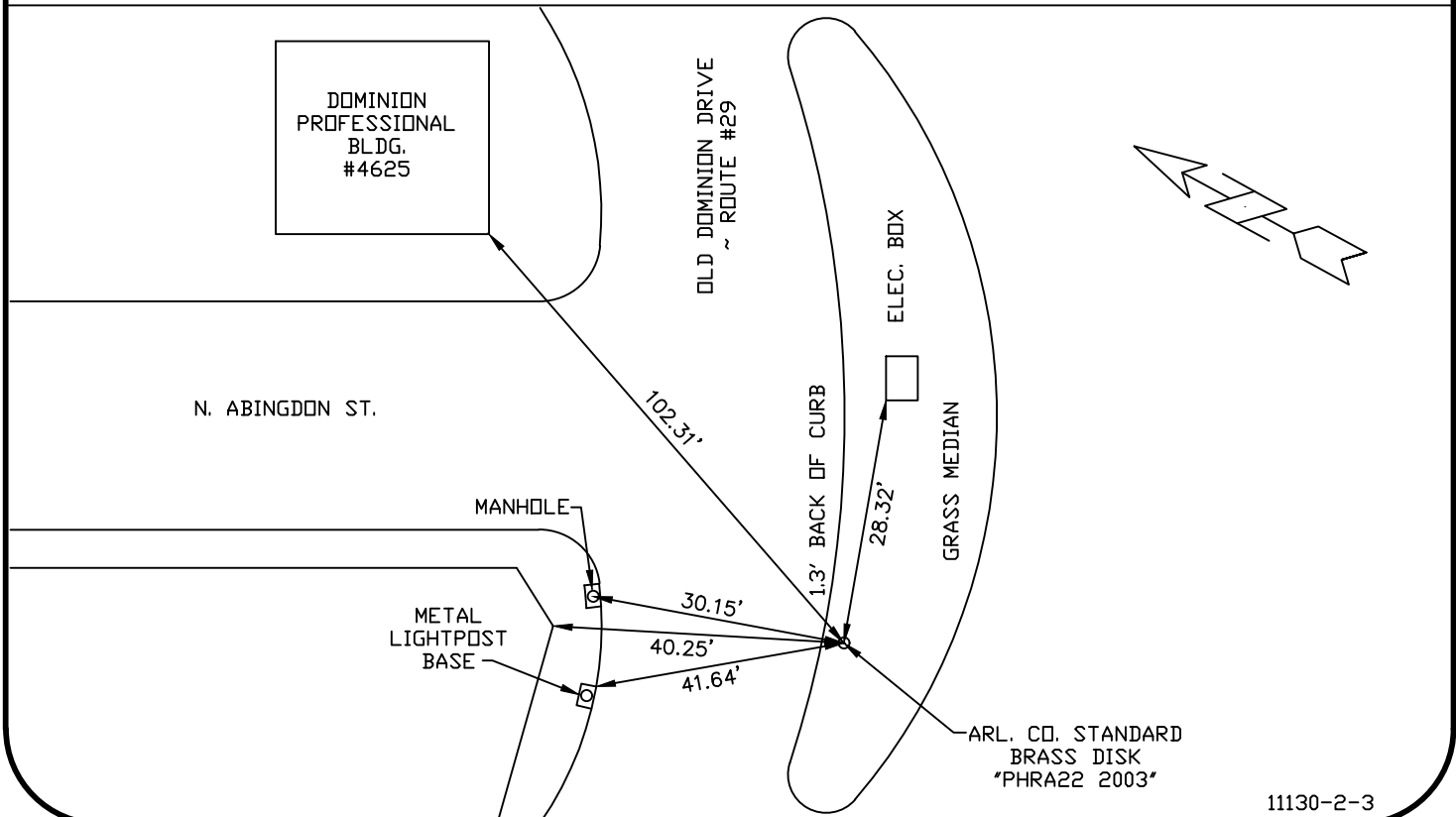

11130-2-3