



ARLINGTON COUNTY, VIRGINIA

DEPARTMENT OF PUBLIC WORKS
ENGINEERING DIVISION
SURVEY SECTION

#1 COURTHOUSE PLAZA, SUITE 813
2100 CLARENDON BOULEVARD
ARLINGTON, VIRGINIA 22201
(703) 228-3686 · FAX (703) 228-3606



R. S. KEM
DIRECTOR OF PUBLIC WORKS

GEODETIC CONTROL SHEET

ADJACENT TO
COURT HOUSE
METRO STATION

DENNIS JOHNSON
DIVISION CHIEF

STATION ID #:

STATION NAME: PHRA21

DATUM: NAD 83 (93)	MAP PROJECTION: Lambert	CONVERSION: US Survey Foot	YEAR: 2003
N: 7,013,521.838	E: 11,876,727.758	Lat: 38° 53'57.4344"N	Lon: 77° 06'58.3289"W
GRID FACTOR: 0.99996045	SCALE FACTOR: 0.99998312	COMBINED FACTOR: 0.99994357	
VERTICAL DATUM: NAVD 88	CONV. ANGLE: 00° 51' 49.1"	REVISION DATE: JULY 2, 2020	
ELEV. (FT): 353.47'	VERTICAL ORDER: Third	HORIZONTAL ORDER: Second	

TO REACH:

The point is located in the grass median at the intersection of Old Dominion Drive, Route #29. and Larcom Lane.
The point is a standard Arlington County brass disk set in concrete.

SKETCH: NOT TO SCALE

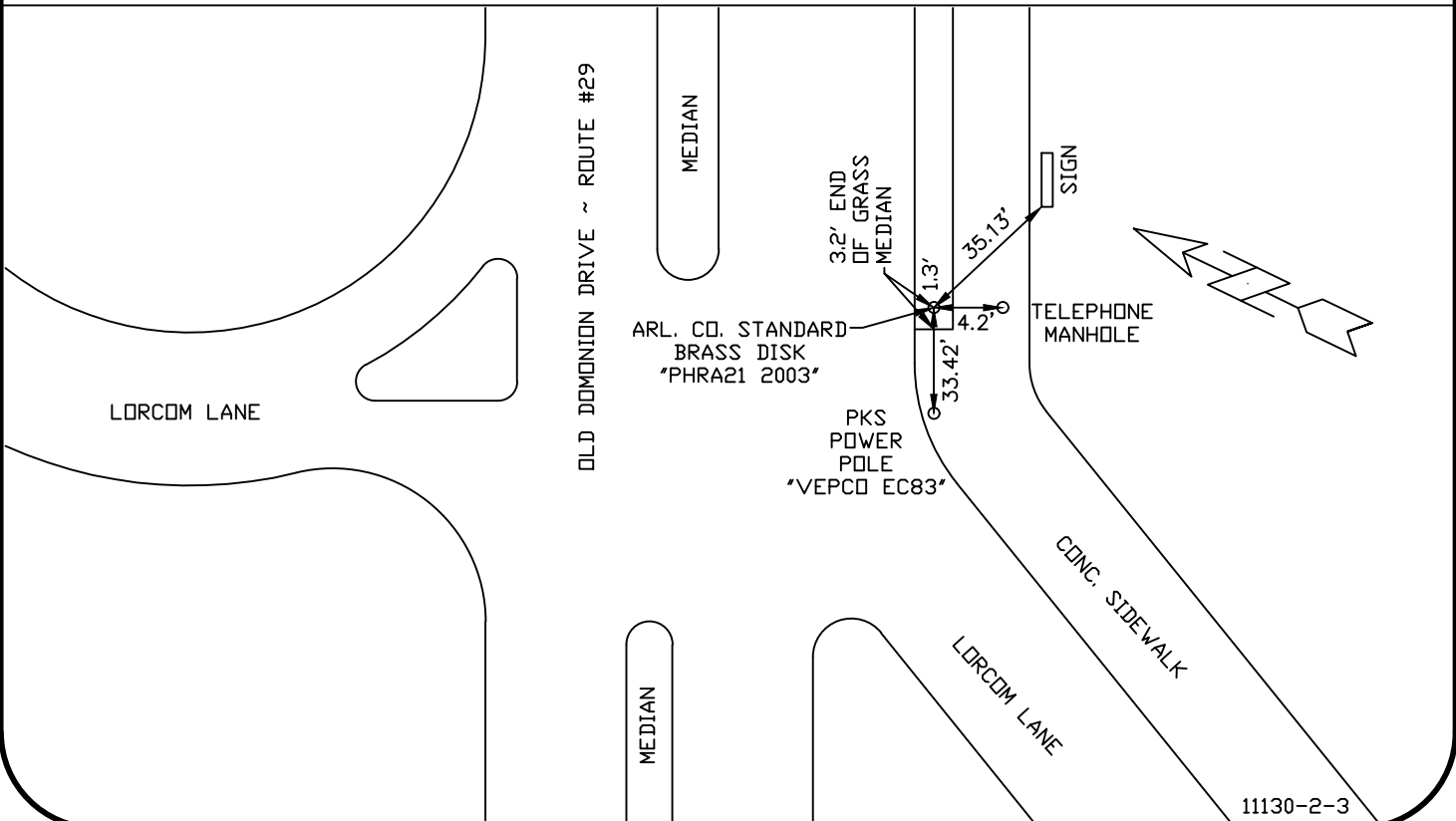

11130-2-3