



ARLINGTON COUNTY, VIRGINIA

DEPARTMENT OF PUBLIC WORKS
ENGINEERING DIVISION
SURVEY SECTION

#1 COURTHOUSE PLAZA, SUITE 813
2100 CLARENDON BOULEVARD
ARLINGTON, VIRGINIA 22201
(703) 228-3686 · FAX (703) 228-3606



R. S. KEM
DIRECTOR OF PUBLIC WORKS

GEODETIC CONTROL SHEET

ADJACENT TO
COURT HOUSE
METRO STATION

DENNIS JOHNSON
DIVISION CHIEF

STATION ID #:

STATION NAME: PHRA18

DATUM: NAD 83 (93)	MAP PROJECTION: Lambert	CONVERSION: US Survey Foot	YEAR: 2003
N: 7,001,350.193	E: 11,888,436.927	Lat: 38° 51'55.3659"N	Lon: 77° 04'32.6211"W
GRID FACTOR: 0.99995772	SCALE FACTOR: 0.99999272	COMBINED FACTOR: 0.99995044	
VERTICAL DATUM: NAVD 88	CONV. ANGLE: 00° 53' 20.1"		
ELEV. (FT): 152.58 ±2cm	VERT. ORDER: GPS	HORIZONTAL ORDER: Second	

TO REACH:

The point is located behind the concrete sidewalk at the intersection of Columbia Pike, Route #244 and S. Rolfe St.
The point is a standard Arlington County brass disk set in concrete.

SKETCH: NOT TO SCALE

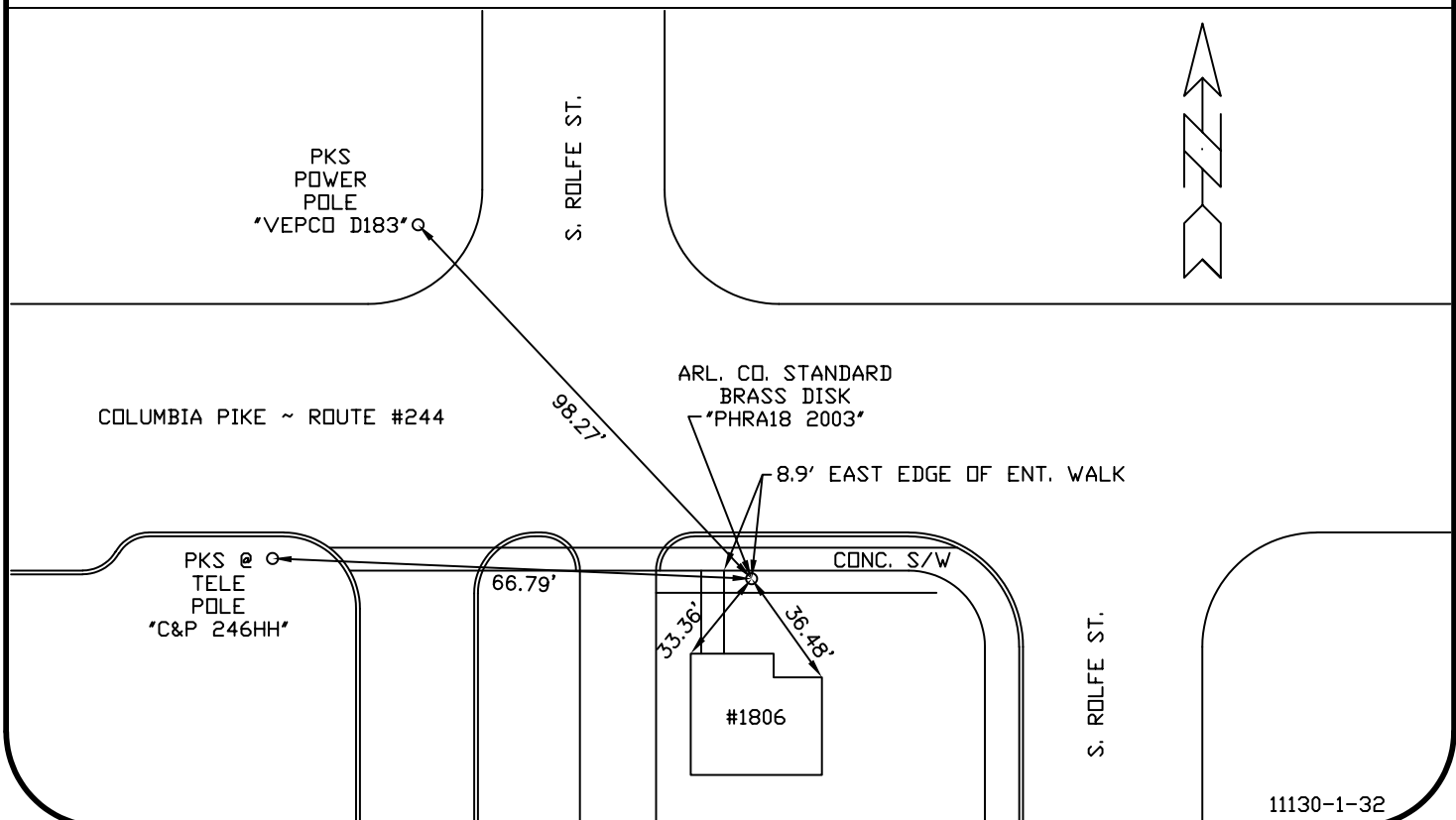

11130-1-32