



ARLINGTON COUNTY, VIRGINIA

DEPARTMENT OF PUBLIC WORKS
ENGINEERING DIVISION
SURVEY SECTION

#1 COURTHOUSE PLAZA, SUITE 813
2100 CLARENDON BOULEVARD
ARLINGTON, VIRGINIA 22201
(703) 228-3686 · FAX (703) 228-3606



R. S. KEM
DIRECTOR OF PUBLIC WORKS

DENNIS JOHNSON
DIVISION CHIEF

GEODETIC CONTROL SHEET

ADJACENT TO
COURT HOUSE
METRO STATION

STATION ID #:

STATION NAME: PHRA16

| | | | |
|-------------------------|----------------------------|-----------------------------------|------------------------|
| DATUM: NAD 83 (93) | MAP PROJECTION: Lambert | CONVERSION: US Survey Foot | YEAR: 2003 |
| N: 7,012,396.243 | E: 11,870,615.636 | Lat: 38° 53'47.2132"N | Lon: 77° 08' 15.8465"W |
| GRID FACTOR: 0.99996021 | SCALE FACTOR: 0.99998215 | COMBINED FACTOR: 0.99994236 | |
| VERTICAL DATUM: NAVD 88 | CONV. ANGLE: 00° 51' 00.8" | REVISION DATE: September 15, 2020 | |
| ELEV. (FT): 373.81' | VERTICAL ORDER: Third | HORIZONTAL ORDER: Second | |

TO REACH:

The point is located on the concrete median at the intersection of Rte 29, Lee Highway and North Harrison Street.
The point is a standard Arlington County brass disk set in concrete.

SKETCH: NOT TO SCALE

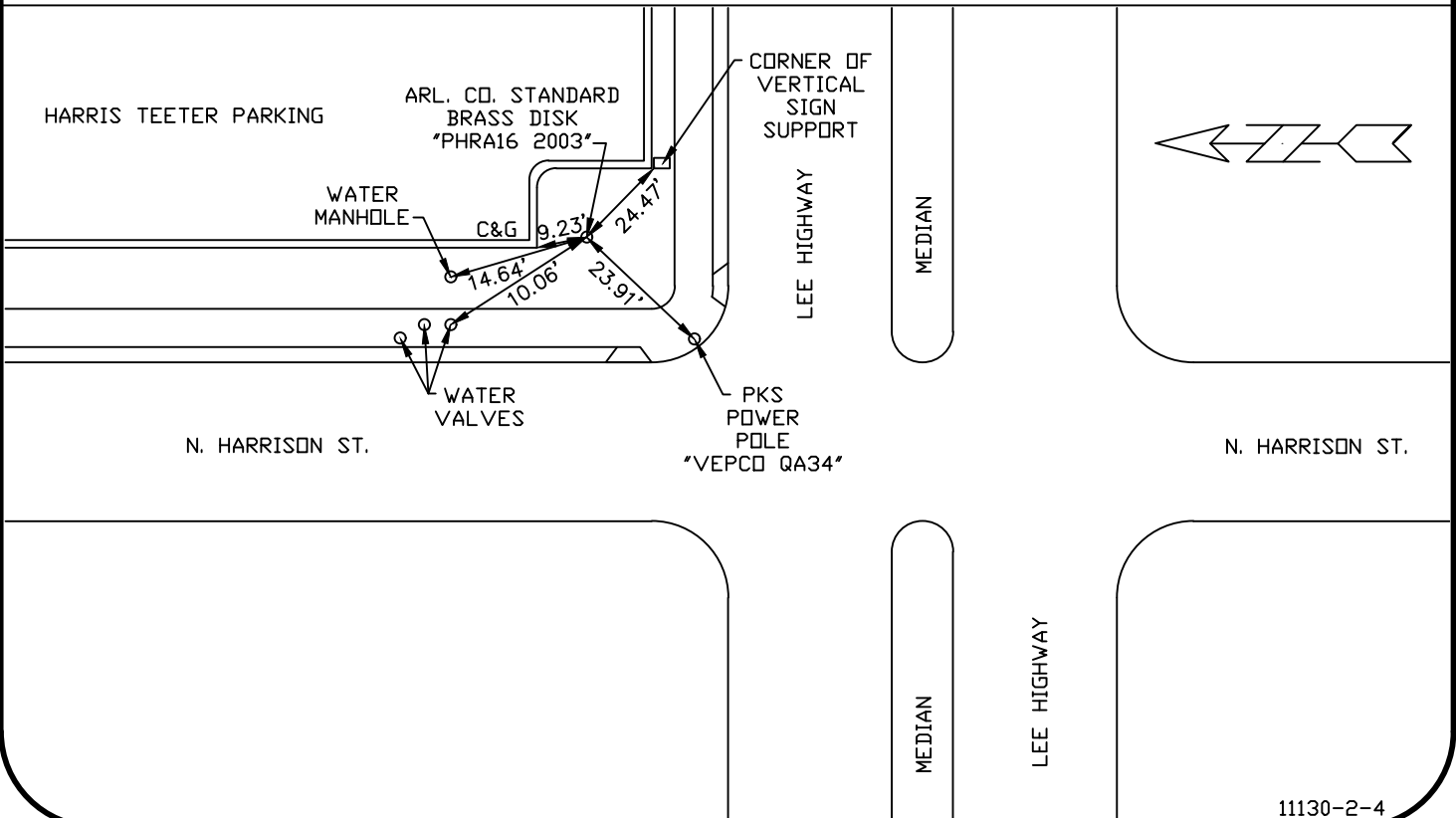

11130-2-4