



# ARLINGTON COUNTY, VIRGINIA

DEPARTMENT OF PUBLIC WORKS  
ENGINEERING DIVISION  
SURVEY SECTION

#1 COURTHOUSE PLAZA, SUITE 813  
2100 CLARENDON BOULEVARD  
ARLINGTON, VIRGINIA 22201  
(703) 228-3686 · FAX (703) 228-3606



R. S. KEM  
DIRECTOR OF PUBLIC WORKS

## GEODETIC CONTROL SHEET

ADJACENT TO  
COURT HOUSE  
METRO STATION

DENNIS JOHNSON  
DIVISION CHIEF

STATION ID #:

STATION NAME: PHRA15

DATUM: NAD 83 (93)	MAP PROJECTION: Lambert	CONVERSION: US Survey Foot	YEAR: 2003
N: 7,013,023.573	E: 11,869,713.421	Lat: 38° 53'53.5456"N	Lon: 77° 08'27.1398"W
GRID FACTOR: 0.99996036	SCALE FACTOR: 0.99998132	COMBINED FACTOR: 0.99994168	
VERTICAL DATUM: NAVD 88	CONV. ANGLE: 00° 50' 53.7"	REVISION DATE: June 26, 2020	
ELEV. (FT): 391.10'	VERTICAL ORDER: Third	HORIZONTAL ORDER: Second	

### TO REACH:

The point is located on the concrete median at the intersection of North Harrison Street and 26th Street North.  
The point is a standard Arlington County brass disk set in concrete.

### SKETCH: NOT TO SCALE

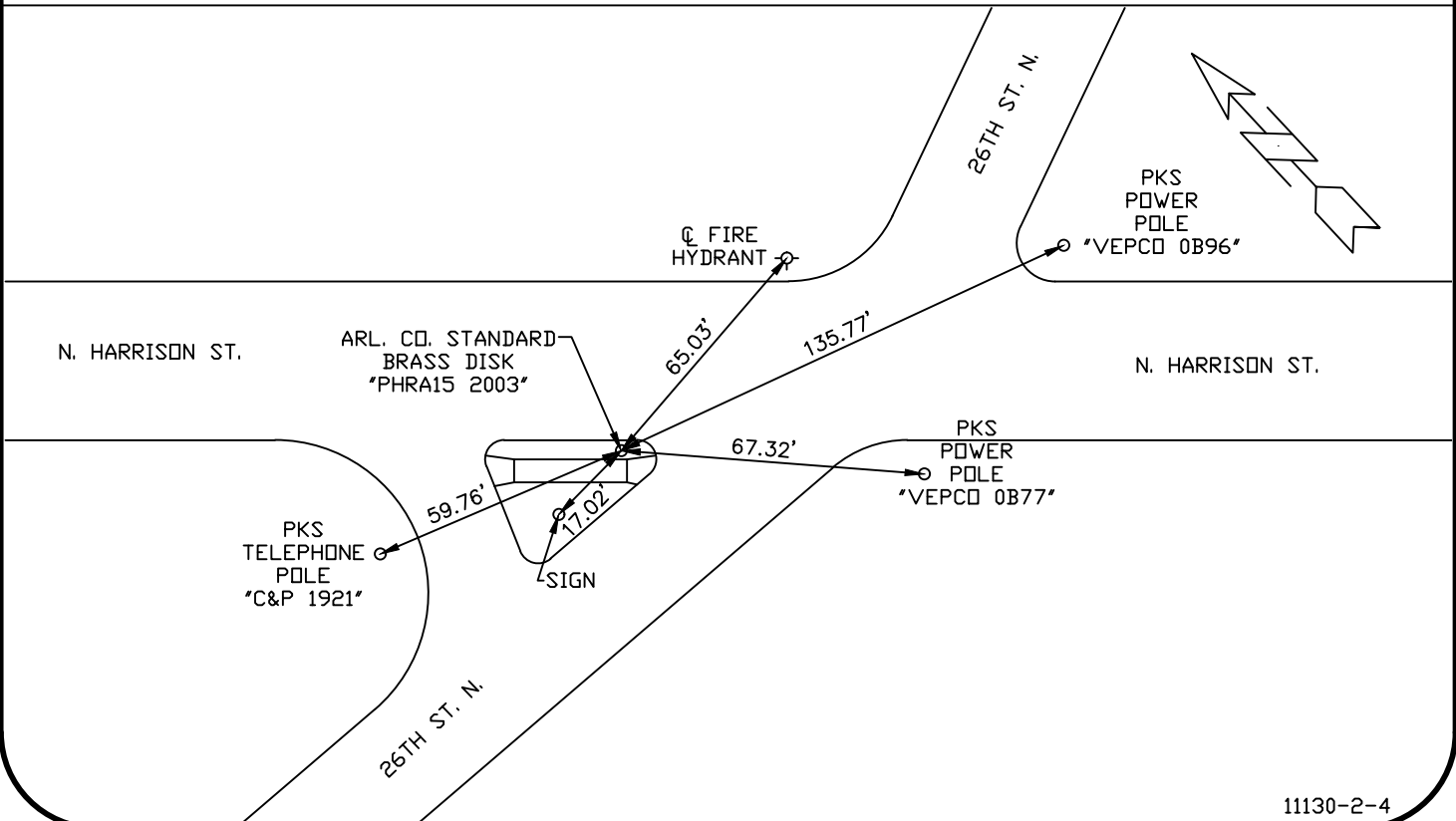

11130-2-4