



ARLINGTON COUNTY, VIRGINIA
 DEPARTMENT OF ENVIRONMENTAL SERVICES
 ENGINEERING AND CAPITAL PROJECTS DIVISION
 SURVEY SECTION

#1 COURTHOUSE PLAZA, SUITE 813
 2100 CLARENDON BOULEVARD
 ARLINGTON, VIRGINIA 22201
 (703) 228-3686 · FAX (703) 228-3606



GEODETTIC CONTROL SHEET

STATION ID #: CP-100	STATION NAME: V1
----------------------	------------------

DATUM: NAD 83 (93)	MAP PROJECTION: Lambert	CONVERSION: US Survey Foot	YEAR: 2009
N: 6,997,516.672	E: 11,874,864.943	Lat: 38° 51' 19.523" N	Lon: 77° 07' 24.925" W
GRID FACTOR: 0.99999312	SCALE FACTOR: 0.99995698	COMBINED FACTOR: 0.99995010	
VERTICAL DATUM: NAVD 88	CONV. ANGLE: +00° 51' 32.55"		
ELEV. (FT): 248.754 ±2cm	VERT. ORDER: GPS	HORIZONTAL ORDER: SECOND	

TO REACH:

The point is located in the grass strip, on the south side of S. Carlin Springs Road, at the intersection of S. Carlin Springs Road and 8th Road S., 9.00' from ex. telephone pole #5520 and 2.00' from the face of curb.

The point is a standard Arlington County 3 1/2" brass disk set on a 600mm Berntsen Feno spike driven flush with the existing grade.

SKETCH: NOT TO SCALE

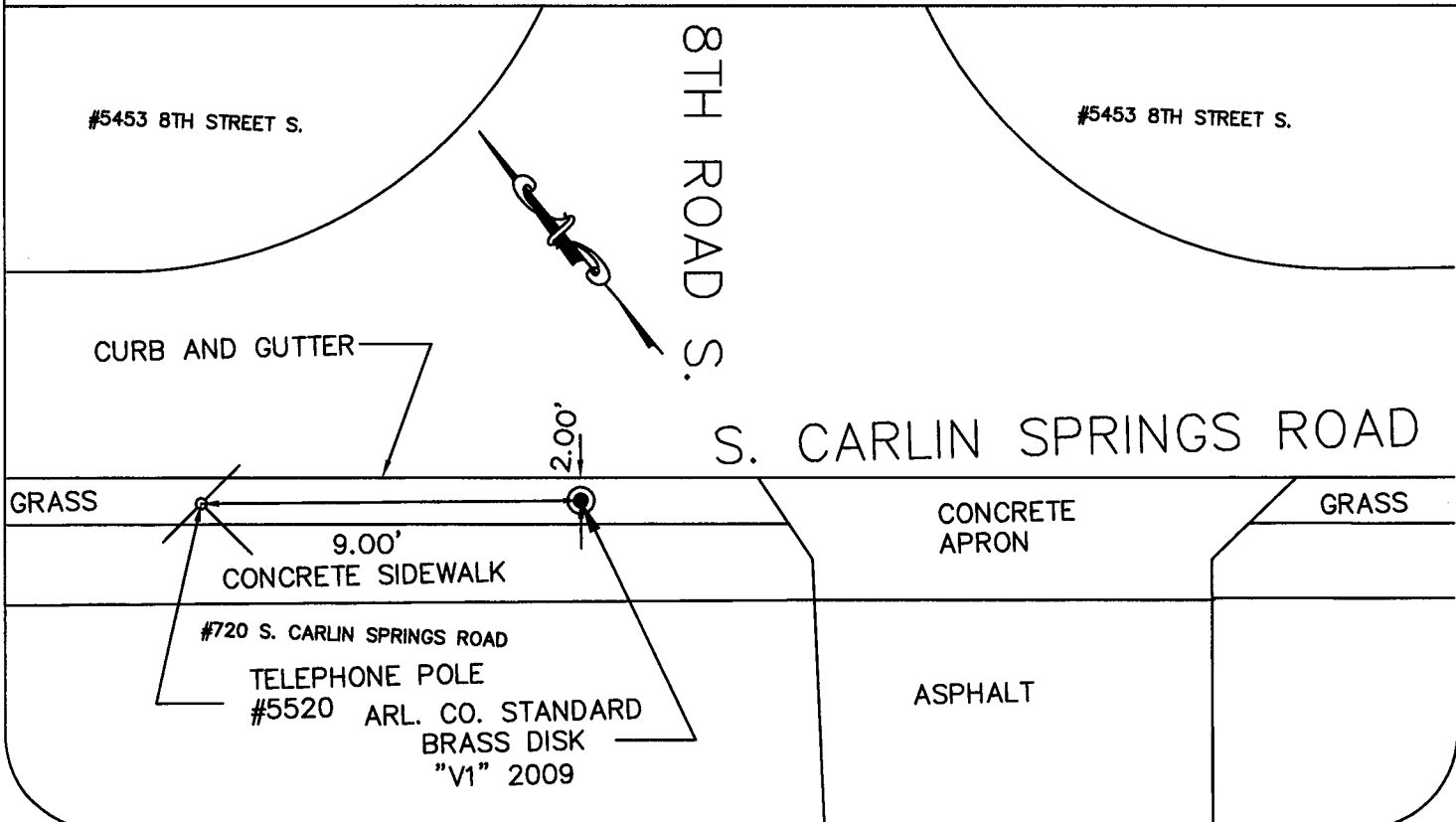



ARLINGTON COUNTY, VIRGINIA
 DEPARTMENT OF ENVIRONMENTAL SERVICES
 ENGINEERING AND CAPITAL PROJECTS DIVISION
 SURVEY SECTION

#1 COURTHOUSE PLAZA, SUITE 813
 2100 CLARENDON BOULEVARD
 ARLINGTON, VIRGINIA 22201
 (703) 228-3686 · FAX (703) 228-3606



GEODETTIC CONTROL SHEET

STATION ID #: CP-101		STATION NAME: V2	
DATUM: NAD 83 (93)	MAP PROJECTION: Lambert	CONVERSION: US Survey Foot	YEAR: 2009
N: 6,997,882.392	E: 11,875,586.466	Lat: 38° 51' 23.031" N	Lon: 77° 07' 15.735" W
GRID FACTOR: 0.99999334	SCALE FACTOR: 0.99995705	COMBINED FACTOR: 0.99995.039	
VERTICAL DATUM: NAVD 88	CONV. ANGLE: +00° 51' 38.29"		
ELEV. (FT): 244.24 ±2cm	VERT. ORDER: GPS	HORIZONTAL ORDER: SECOND	

TO REACH:

The point is located in the grass strip, on the north side of 8th Road S., at the intersection of S. Harrison Street and 8th Road S., 18.65' from Vepco power pole BB76 and 30.20' from a sanitary sewer manhole.
 The point is a standard Arlington County 3 1/2" brass disk set on a 600mm Berntsen Feno spike driven flush with the existing grade.

SKETCH: NOT TO SCALE

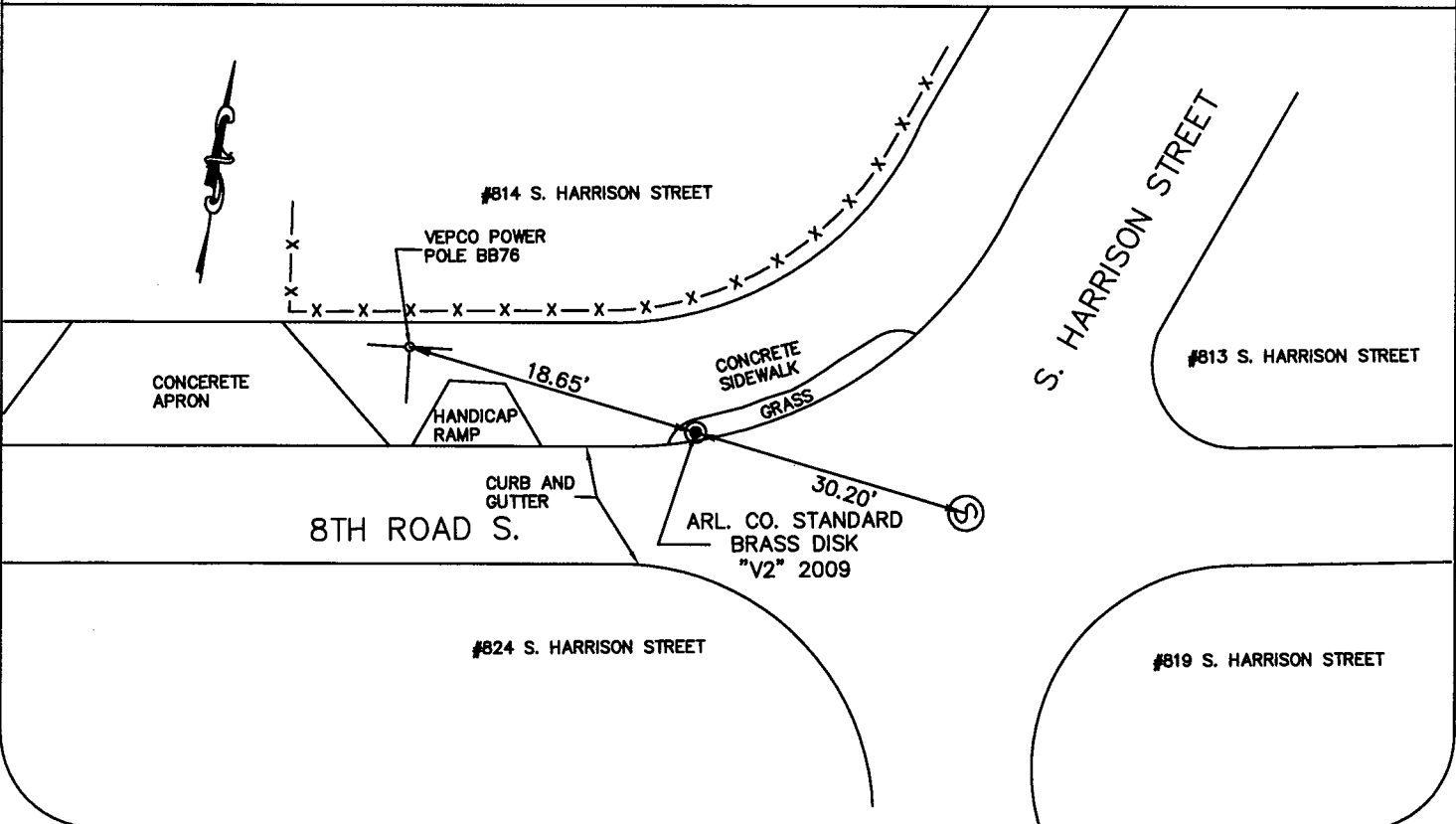



ARLINGTON COUNTY, VIRGINIA
 DEPARTMENT OF ENVIROMENTAL SERVICES
 ENGINEERING AND CAPITAL PROJECTS DIVISION
 SURVEY SECTION

#1 COURTHOUSE PLAZA, SUITE 813
 2100 CLARENDON BOULEVARD
 ARLINGTON, VIRGINIA 22201
 (703) 228-3686 · FAX (703) 228-3606



GEODETTIC CONTROL SHEET

STATION ID #: CP-102		STATION NAME: V3	
DATUM: NAD 83 (93)	MAP PROJECTION: Lambert	CONVERSION: US Survey Foot	YEAR: 2009
N: 6,997,925.107	E: 11,876,131.600	Lat: 38° 51' 23.372" N	Lon: 77° 07' 08.837" W
GRID FACTOR: 0.99999433	SCALE FACTOR: 0.99995706	COMBINED FACTOR: 0.99995139	
VERTICAL DATUM: NAVD 88	CONV. ANGLE: +00° 51' 42.6"		
ELEV. (FT): 223.45 ±2cm	VERT. ORDER: GPS	HORIZONTAL ORDER: SECOND	

TO REACH:

The point is located in the grass strip, on the south side of 8th Road S., at the intersection of S. Greenbrier Street and 8th Road S, 16.20' from a storm drain manhole located in the street, and 16.60' from a water manhole.

The point is a standard Arlington County 3 1/2" brass disk set on a 600mm Berntsen Feno spike driven flush with the existing grade.

SKETCH: NOT TO SCALE

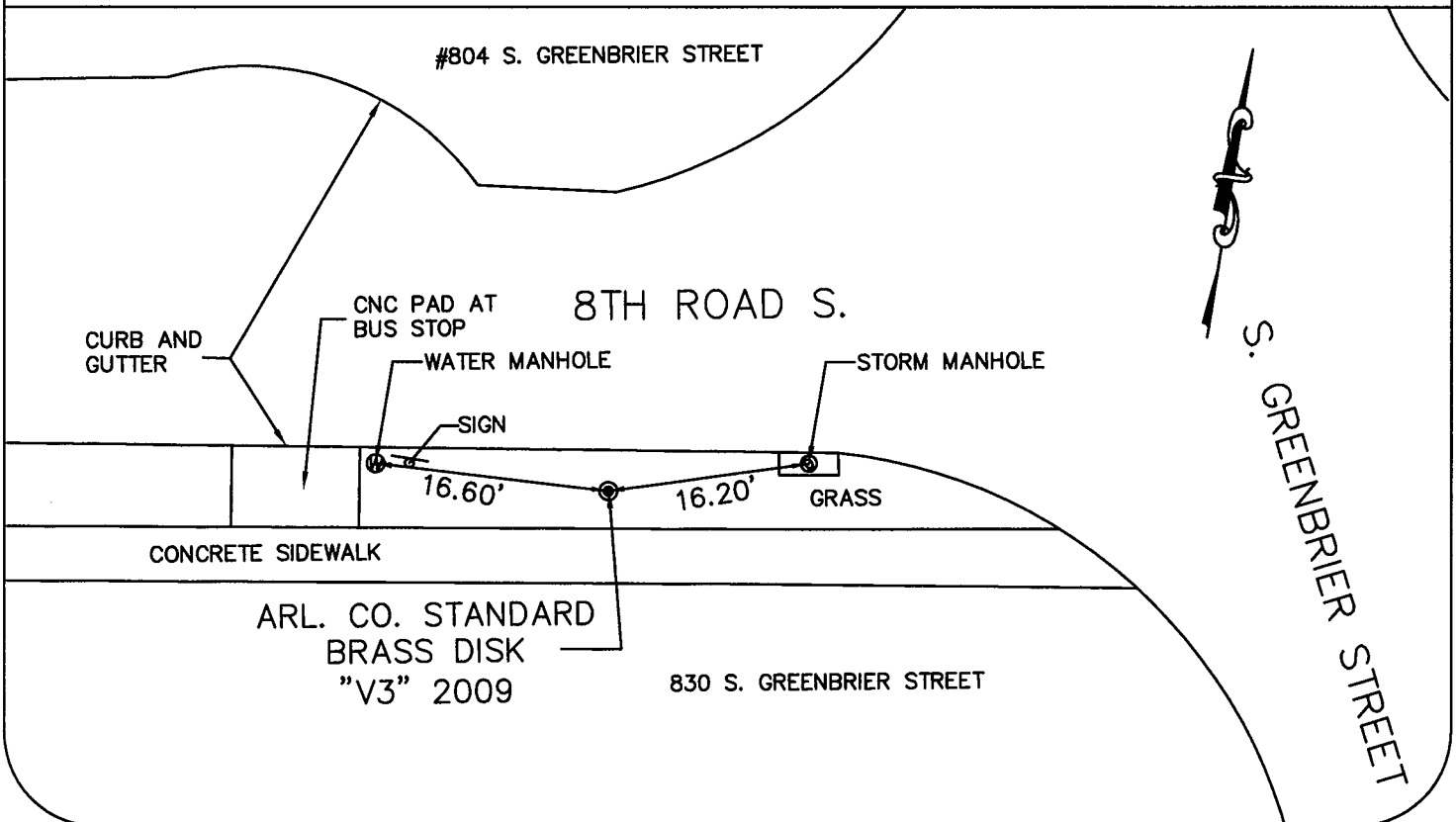



ARLINGTON COUNTY, VIRGINIA
 DEPARTMENT OF ENVIRONMENTAL SERVICES
 ENGINEERING AND CAPITAL PROJECTS DIVISION
 SURVEY SECTION

#1 COURTHOUSE PLAZA, SUITE 813
 2100 CLARENDON BOULEVARD
 ARLINGTON, VIRGINIA 22201
 (703) 228-3686 · FAX (703) 228-3606



GEODETTIC CONTROL SHEET

STATION ID #: CP-103		STATION NAME: V4	
DATUM: NAD 83 (93)	MAP PROJECTION: Lambert	CONVERSION: US Survey Foot	YEAR: 2009
N: 6,998,047.392	E: 11,876,572.781	Lat: 38° 51' 24.515" N	Lon: 77° 07' 03.237" W
GRID FACTOR: 0.99999386	SCALE FACTOR: 0.99995708	COMBINED FACTOR: 0.99995094	
VERTICAL DATUM: NAVD 88	CONV. ANGLE: +00° 51' 46.1"		
ELEV. (FT): 233.28 ±2cm	VERT. ORDER: GPS	HORIZONTAL ORDER: SECOND	

TO REACH:

The point is located in the grass strip, on the north side of 8th Road S., at the intersection of S. Florida Street and 8th Road S, 15.10' from the southwest corner of a catch basin and 46.40' from the southwest corner of a 3 story brick building with an address of #821.

The point is a standard Arlington County 3 1/2" brass disk set on a 600mm Berntsen Feno spike driven flush with the existing grade.

SKETCH: NOT TO SCALE

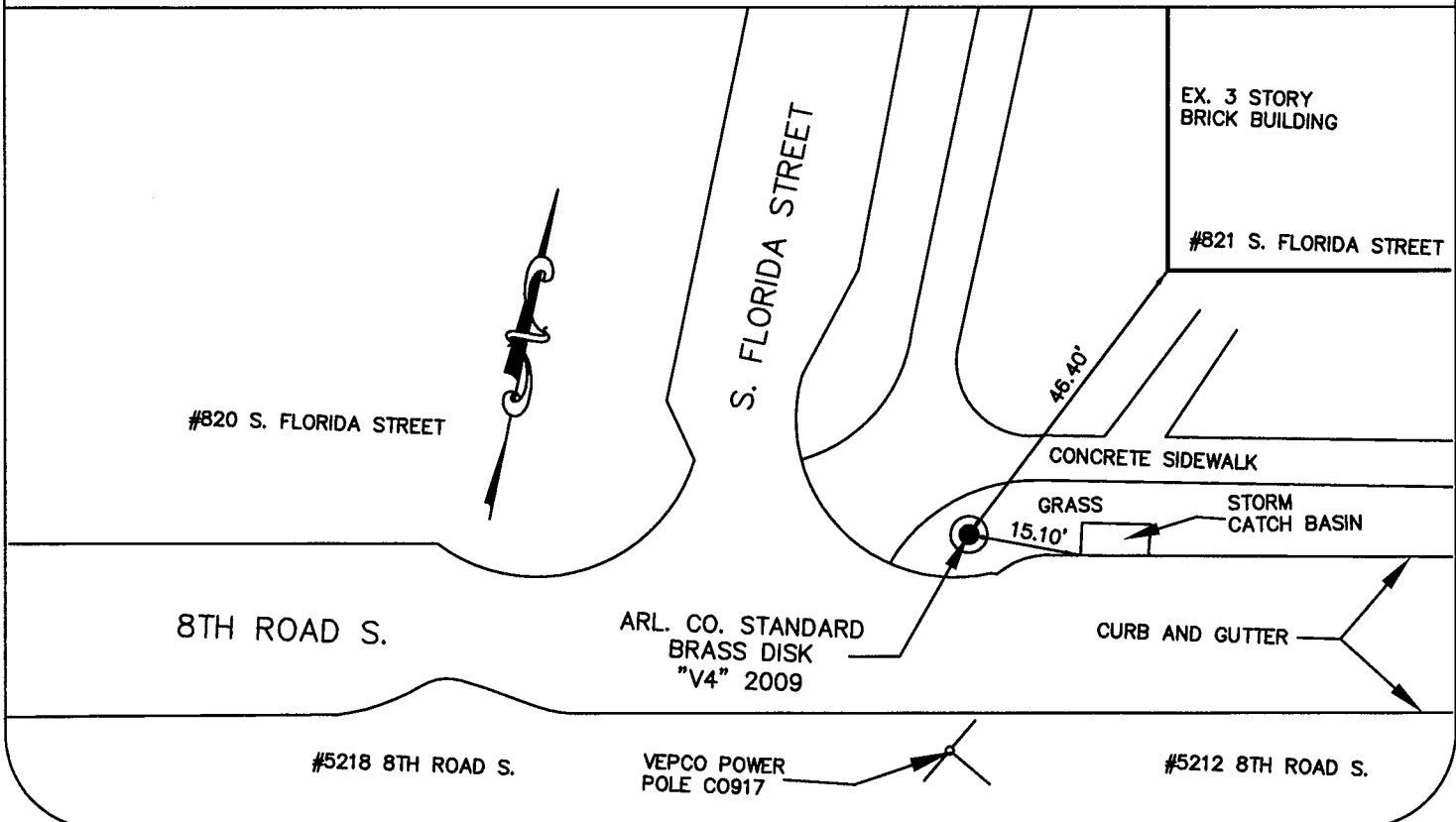



ARLINGTON COUNTY, VIRGINIA
 DEPARTMENT OF ENVIROMENTAL SERVICES
 ENGINEERING AND CAPITAL PROJECTS DIVISION
 SURVEY SECTION

#1 COURTHOUSE PLAZA, SUITE 813
 2100 CLARENDON BOULEVARD
 ARLINGTON, VIRGINIA 22201
 (703) 228-3686 · FAX (703) 228-3606



GEODETTIC CONTROL SHEET

STATION ID #: CP-104		STATION NAME: V5	
DATUM: NAD 83 (93)	MAP PROJECTION: Lambert	CONVERSION: US Survey Foot	YEAR: 2009
N: 6,998,242.669	E: 11,877,013.720	Lat: 38° 51' 26.380" N	Lon: 77° 06' 57.626" W
GRID FACTOR: 0.99999320	SCALE FACTOR: 0.99995712	COMBINED FACTOR: 0.99995033	
VERTICAL DATUM: NAVD 88	CONV. ANGLE: +00° 51' 49.6"		
ELEV. (FT): 247.00 ±2cm	VERT. ORDER: GPS	HORIZONTAL ORDER: SECOND	

TO REACH:

The point is located in the grass strip along the north side of 8th Road S, between the streets of S. Frederick Street and S. Emerson Street. The point is located 26.10' from the center of a fire hydrant and 2.00' from the face of curb. The point is a standard Arlington County 3 1/2" brass disk set on a 600mm Berntsen Feno spike driven flush with the existing grade.

SKETCH: NOT TO SCALE

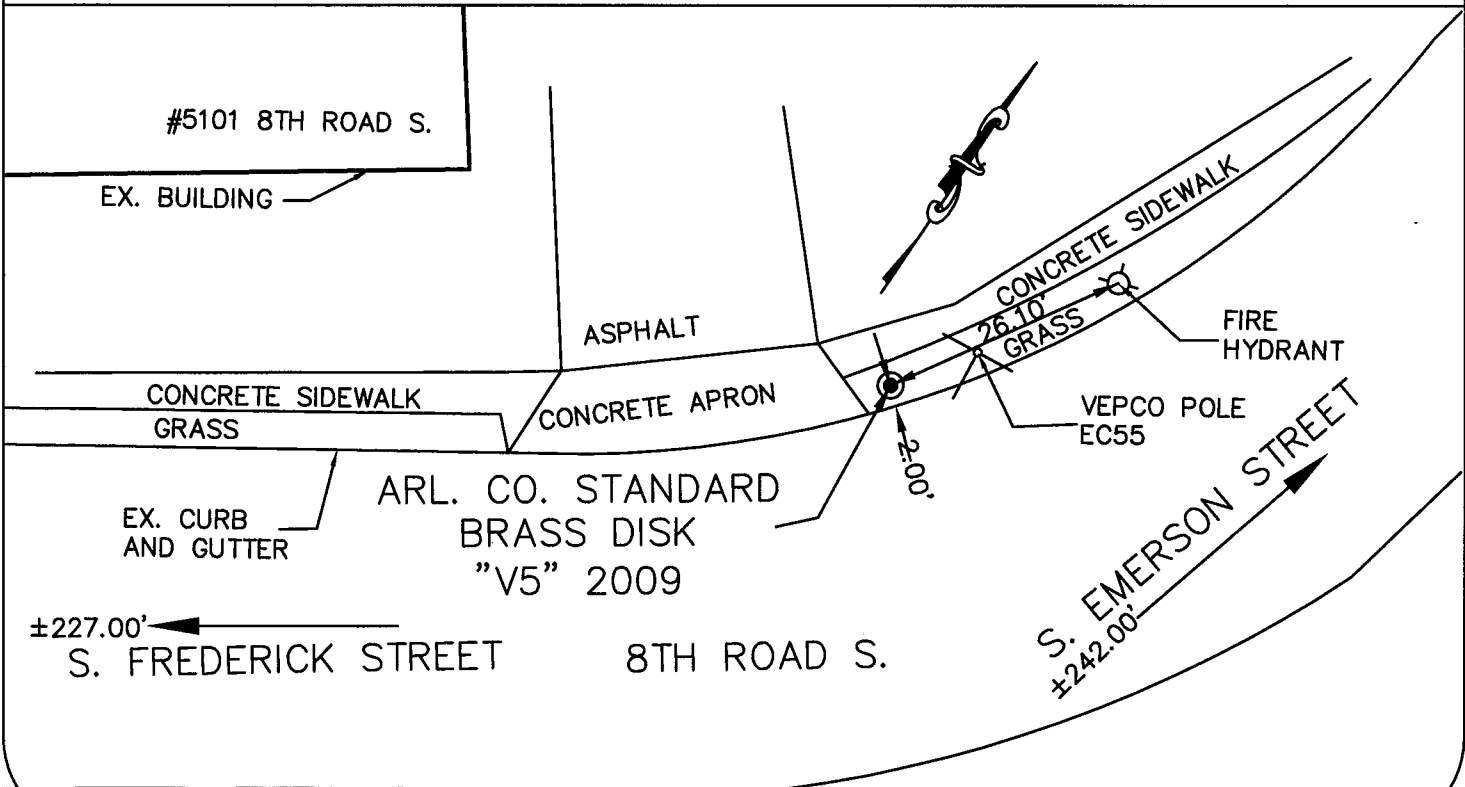



ARLINGTON COUNTY, VIRGINIA
 DEPARTMENT OF ENVIROMENTAL SERVICES
 ENGINEERING AND CAPITAL PROJECTS DIVISION
 SURVEY SECTION

#1 COURTHOUSE PLAZA, SUITE 813
 2100 CLARENDON BOULEVARD
 ARLINGTON, VIRGINIA 22201
 (703) 228-3686 · FAX (703) 228-3606



GEODETTIC CONTROL SHEET

STATION ID #: CP-105		STATION NAME: V6	
DATUM: NAD 83 (93)	MAP PROJECTION: Lambert	CONVERSION: US Survey Foot	YEAR: 2009
N: 6,998,562.591	E: 11,877,140.437	Lat: 38° 51' 29.523" N	Lon: 77° 06' 55.963" W
GRID FACTOR: 0.99999489	SCALE FACTOR: 0.99995719	COMBINED FACTOR: 0.99995208	
VERTICAL DATUM: NAVD 88	CONV. ANGLE: +00° 51' 50.6"		
ELEV. (FT): 211.70 ±2cm	VERT. ORDER: GPS	HORIZONTAL ORDER: SECOND	

TO REACH:

The point is located in the grass strip along the north side of 8th Road S, between the streets of S. Dinwiddle Street and S. Emerson Street. The point is located 9.05' from the corner of a catch basin and 9.60' from Vepco power pole FC97. The point is a standard Arlington County 3 1/2" brass disk set on a 600mm Berntsen FEno spike driven flush with the existing grade.

SKETCH: NOT TO SCALE

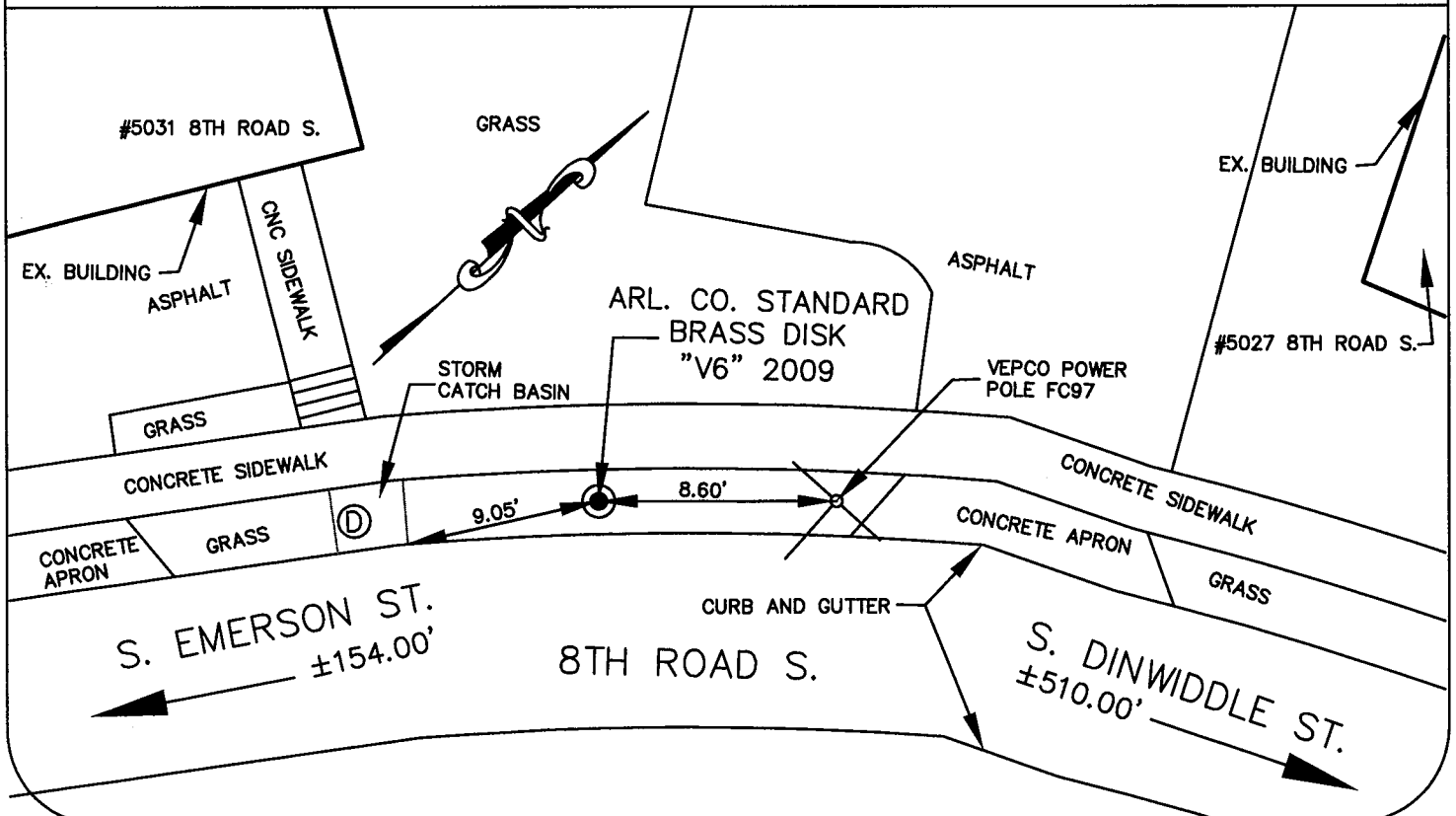



ARLINGTON COUNTY, VIRGINIA
 DEPARTMENT OF ENVIRONMENTAL SERVICES
 ENGINEERING AND CAPITAL PROJECTS DIVISION
 SURVEY SECTION

#1 COURTHOUSE PLAZA, SUITE 813
 2100 CLARENDON BOULEVARD
 ARLINGTON, VIRGINIA 22201
 (703) 228-3686 · FAX (703) 228-3606



GEODETTIC CONTROL SHEET

STATION ID #: CP-106	STATION NAME: V7
----------------------	------------------

DATUM: NAD 83 (93)	MAP PROJECTION: Lambert	CONVERSION: US Survey Foot	YEAR: 2009
N: 6,998,771.716	E: 11,878,974.255	Lat: 38° 51' 31.315" N	Lon: 77° 06' 32.742" W
GRID FACTOR: 0.99999580	SCALE FACTOR: 0.99995722	COMBINED FACTOR: 0.99995302	
VERTICAL DATUM: NAVD 88	CONV. ANGLE: +00° 52' 05.1"		
ELEV. (FT): 192.74 ±2cm	VERT. ORDER: GPS	HORIZONTAL ORDER: SECOND	

TO REACH:

The point is located in the grass strip along the south side of 9th Street S, between the streets of S. Buchanan Street and S. Wakefield Street. The point is located 7.40' from the water meter located at house #4718 and 1.60' from the existing curb and gutter.

The point is a standard Arlington County 3 1/2" brass disk set on a 600mm Berntsen Feno spike driven flush with the existing grade.

SKETCH: NOT TO SCALE

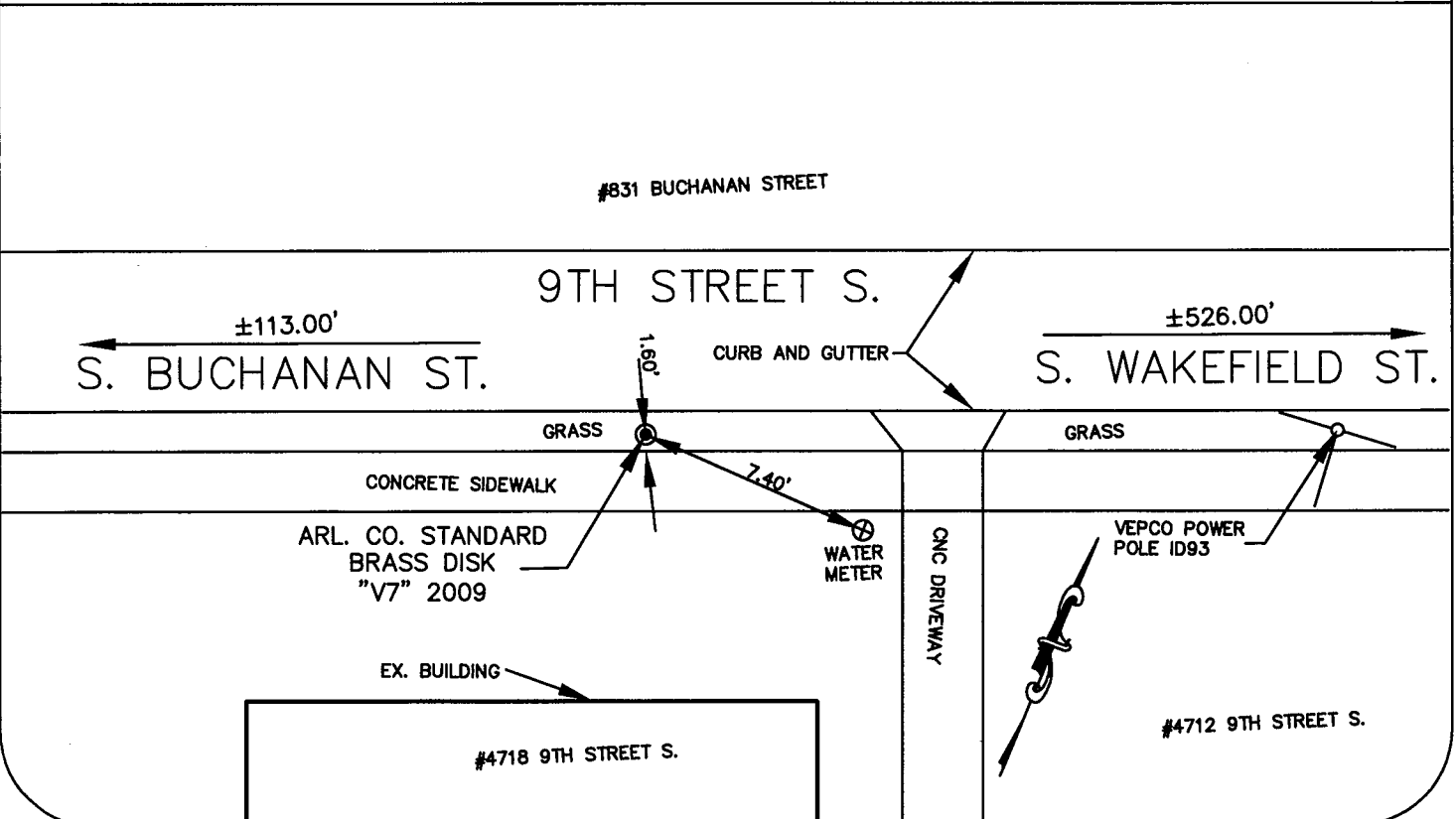



ARLINGTON COUNTY, VIRGINIA
 DEPARTMENT OF ENVIROMENTAL SERVICES
 ENGINEERING AND CAPITAL PROJECTS DIVISION
 SURVEY SECTION

#1 COURTHOUSE PLAZA, SUITE 813
 2100 CLARENDON BOULEVARD
 ARLINGTON, VIRGINIA 22201
 (703) 228-3686 · FAX (703) 228-3606



GEODETTIC CONTROL SHEET

STATION ID #: CP-107	STATION NAME: V8
----------------------	------------------

DATUM: NAD 83 (93)	MAP PROJECTION: Lambert	CONVERSION: US Survey Foot	YEAR: 2009
N: 6,999,121.720	E: 11,879,818.070	Lat: 38° 51' 34.648" N	Lon: 77° 06' 22.008" W
GRID FACTOR: 0.99999510	SCALE FACTOR: 0.99995729	COMBINED FACTOR: 0.99995239	
VERTICAL DATUM: NAVD 88	CONV. ANGLE: +00° 52' 11.8"		
ELEV. (FT): 207.32 ±2cm	VERT. ORDER: GPS	HORIZONTAL ORDER: SECOND	

TO REACH:

The point is located in the grass strip, on the south side of 9th Street S., at the intersection of 9th Street S. and S. Utah Street. The point is located 16.65' from the western most water valve from a cluster of 3 and 13.25' from a sign. The point is a standard Arlington County 3 1/2" brass disk set on a 600mm Berntsen Feno spike driven flush with the existing grade.

SKETCH: NOT TO SCALE

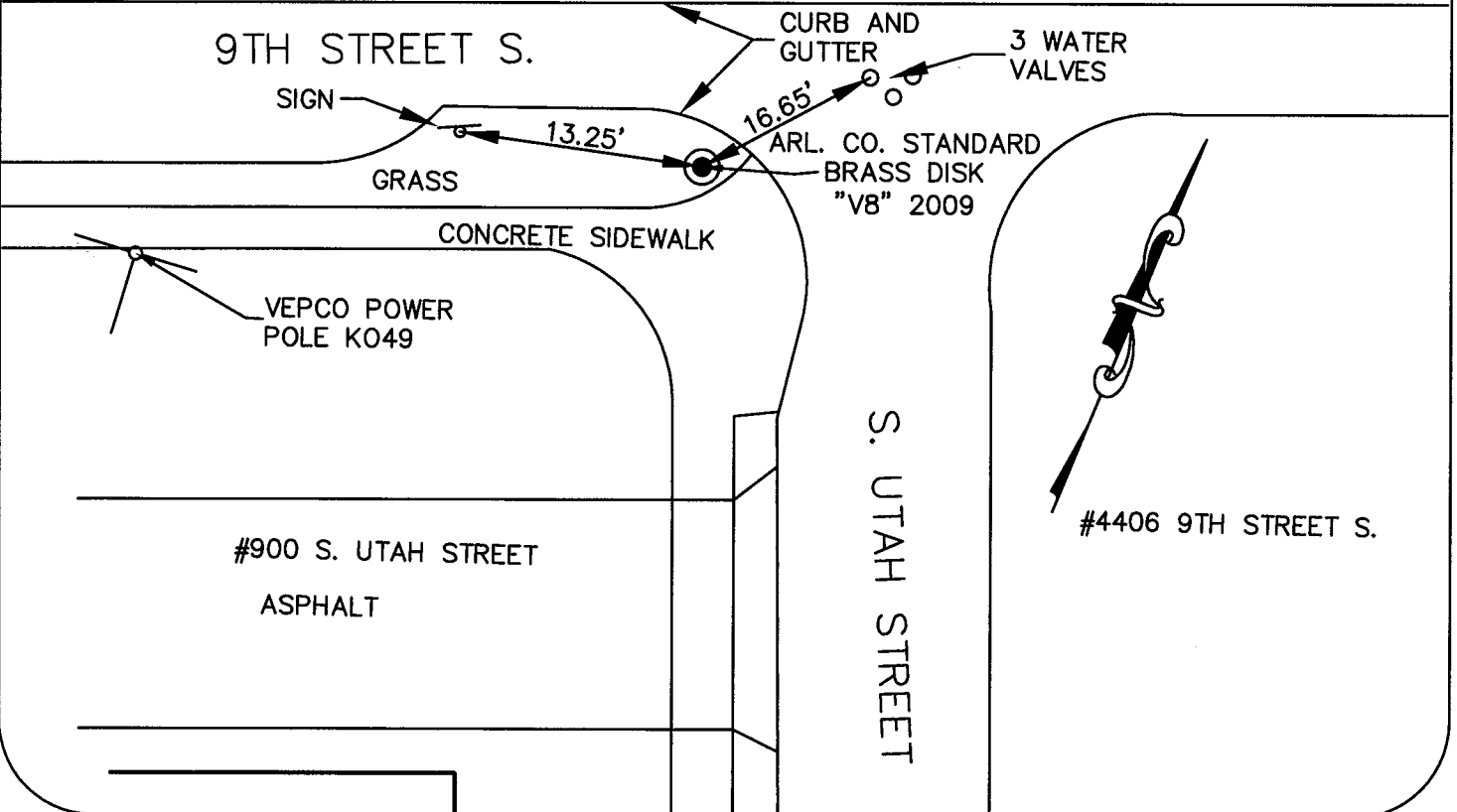



ARLINGTON COUNTY, VIRGINIA
 DEPARTMENT OF ENVIROMENTAL SERVICES
 ENGINEERING AND CAPITAL PROJECTS DIVISION
 SURVEY SECTION

#1 COURTHOUSE PLAZA, SUITE 813
 2100 CLARENDON BOULEVARD
 ARLINGTON, VIRGINIA 22201
 (703) 228-3686 · FAX (703) 228-3606



GEODETTIC CONTROL SHEET

STATION ID #: CP-108		STATION NAME: V9	
DATUM: NAD 83 (93)	MAP PROJECTION: Lambert	CONVERSION: US Survey Foot	YEAR: 2009
N: 6,999,613.449	E: 11,881,931.845	Lat: 38° 51' 39.190" N	Lon: 77° 05' 55.193" W
GRID FACTOR: 0.99999571	SCALE FACTOR: 0.99995738	COMBINED FACTOR: 0.99995310	
VERTICAL DATUM: NAVD 88	CONV. ANGLE: +00° 52' 28.5"		
ELEV. (FT): 194.59 ±2cm	VERT. ORDER: GPS	HORIZONTAL ORDER: SECOND	

TO REACH:

The point is located in the grass strip, on the South side of 9th Street S., near the intersection of 9th Street S. and S. Quincy Street. The point is located 28.55' from the water meter for house #3920 and 2.00' from the face of curb. The point is a standard Arlington County 3 1/2" brass disk set on a 600mm Berntsen Feno spike driven flush with the existing grade.

SKETCH: NOT TO SCALE

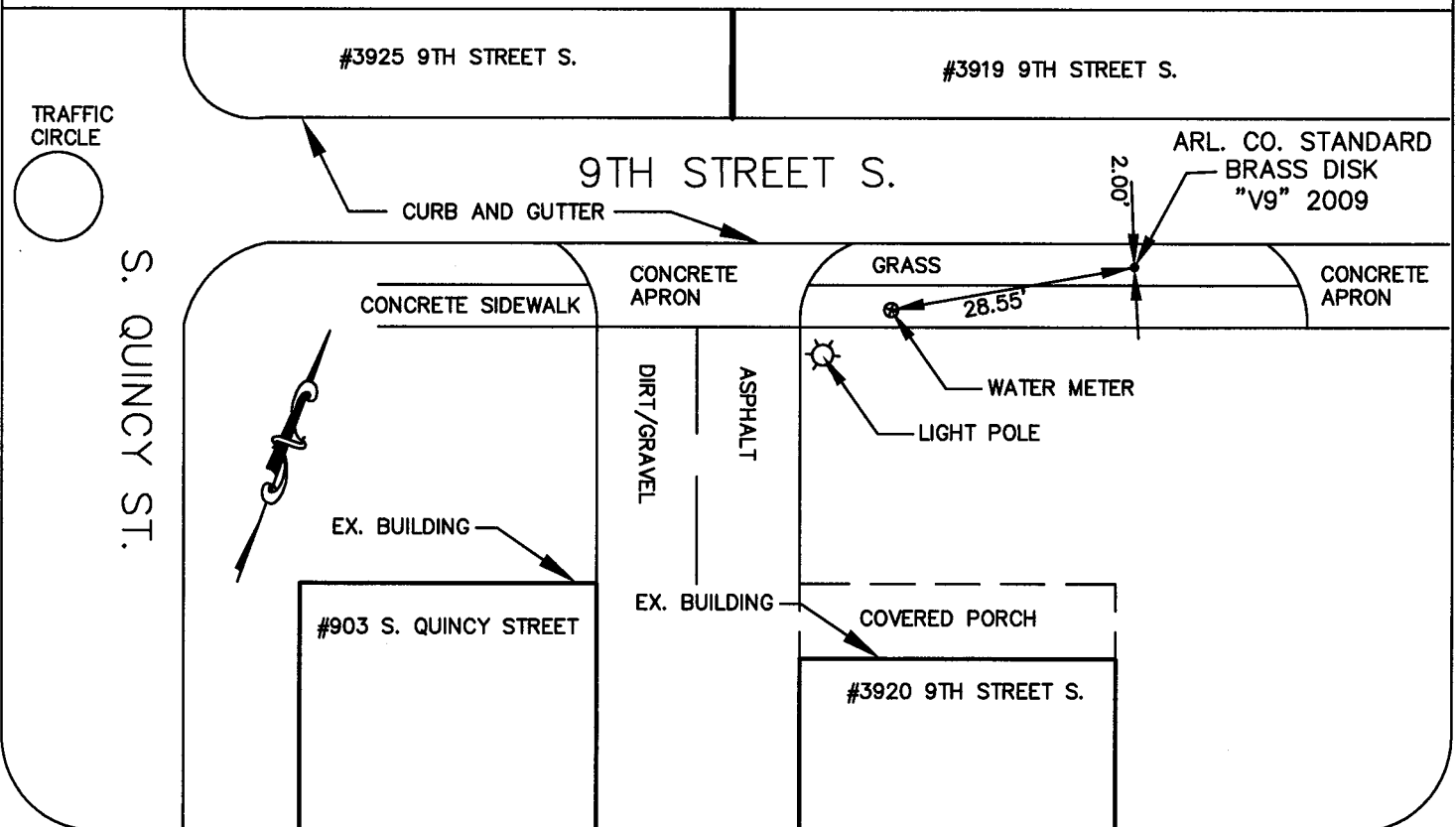



ARLINGTON COUNTY, VIRGINIA
 DEPARTMENT OF ENVIROMENTAL SERVICES
 ENGINEERING AND CAPITAL PROJECTS DIVISION
 SURVEY SECTION

#1 COURTHOUSE PLAZA, SUITE 813
 2100 CLARENDON BOULEVARD
 ARLINGTON, VIRGINIA 22201
 (703) 228-3686 · FAX (703) 228-3606



GEODETC CONTROL SHEET

STATION ID #: CP-109		STATION NAME: V10	
DATUM: NAD 83 (93)	MAP PROJECTION: Lambert	CONVERSION: US Survey Foot	YEAR: 2009
N: 6,999,964.087	E: 11,882,786.240	Lat: 38° 51' 42.527" N	Lon: 77° 05' 44.325" W
GRID FACTOR: 0.99999549	SCALE FACTOR: 0.99995745	COMBINED FACTOR: 0.99995295	
VERTICAL DATUM: NAVD 88	CONV. ANGLE: +00° 52' 35.3"		
ELEV. (FT): 199.19 ±2cm	VERT. ORDER: GPS	HORIZONTAL ORDER: SECOND	

TO REACH:

The point is located in the grass strip along the north side of 9th Street S., between the streets of S. Oakland Street and S. Monroe Street. The point is 21.80 from the water meter for house #3705 and 36.30' from power pole #1142H. The point is a standard Arlington County 3 1/2" brass disk set on a 600mm Berntsen Feno spike driven flush with the existing grade.

SKETCH: NOT TO SCALE

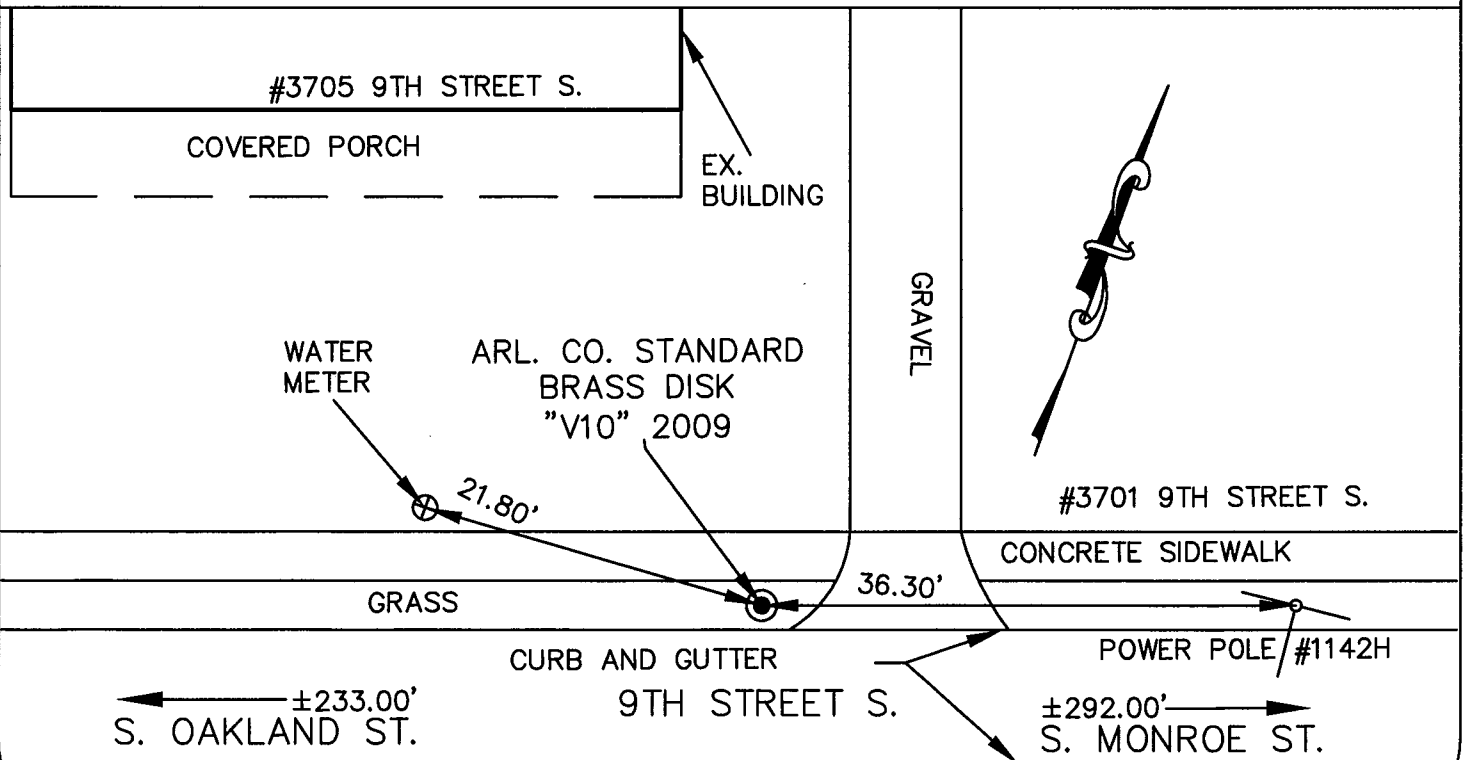



ARLINGTON COUNTY, VIRGINIA
 DEPARTMENT OF ENVIROMENTAL SERVICES
 ENGINEERING AND CAPITAL PROJECTS DIVISION
 SURVEY SECTION

#1 COURTHOUSE PLAZA, SUITE 813
 2100 CLARENDON BOULEVARD
 ARLINGTON, VIRGINIA 22201
 (703) 228-3686 · FAX (703) 228-3606



GEODETTIC CONTROL SHEET

STATION ID #: CP-110	STATION NAME: V11
----------------------	-------------------

DATUM: NAD 83 (93)	MAP PROJECTION: Lambert	CONVERSION: US Survey Foot	YEAR: 2009
N: 7,000,204.432	E: 11,883,453.448	Lat: 38° 51' 44.801" N	Lon: 77° 05' 35.844" W
GRID FACTOR: 0.99999528	SCALE FACTOR: 0.99995750	COMBINED FACTOR: 0.99995278	
VERTICAL DATUM: NAVD 88	CONV. ANGLE: +00° 52' 40.6"		
ELEV. (FT): 203.61 ±2cm	VERT. ORDER: GPS	HORIZONTAL ORDER: SECOND	

TO REACH:

The point is located in the grass area located, on the north side of 9th Street S., at the intersection of 9th Street S. and S. Lincoln Street, 44.20' from the center of a sanitary sewer manhole located in the traffic circle and 12.00 from a utility pole. The point is a standard Arlington County 3 1/2" brass disk set on a 600mm Berntsen Feno spike driven flush with the existing grade.

SKETCH: NOT TO SCALE

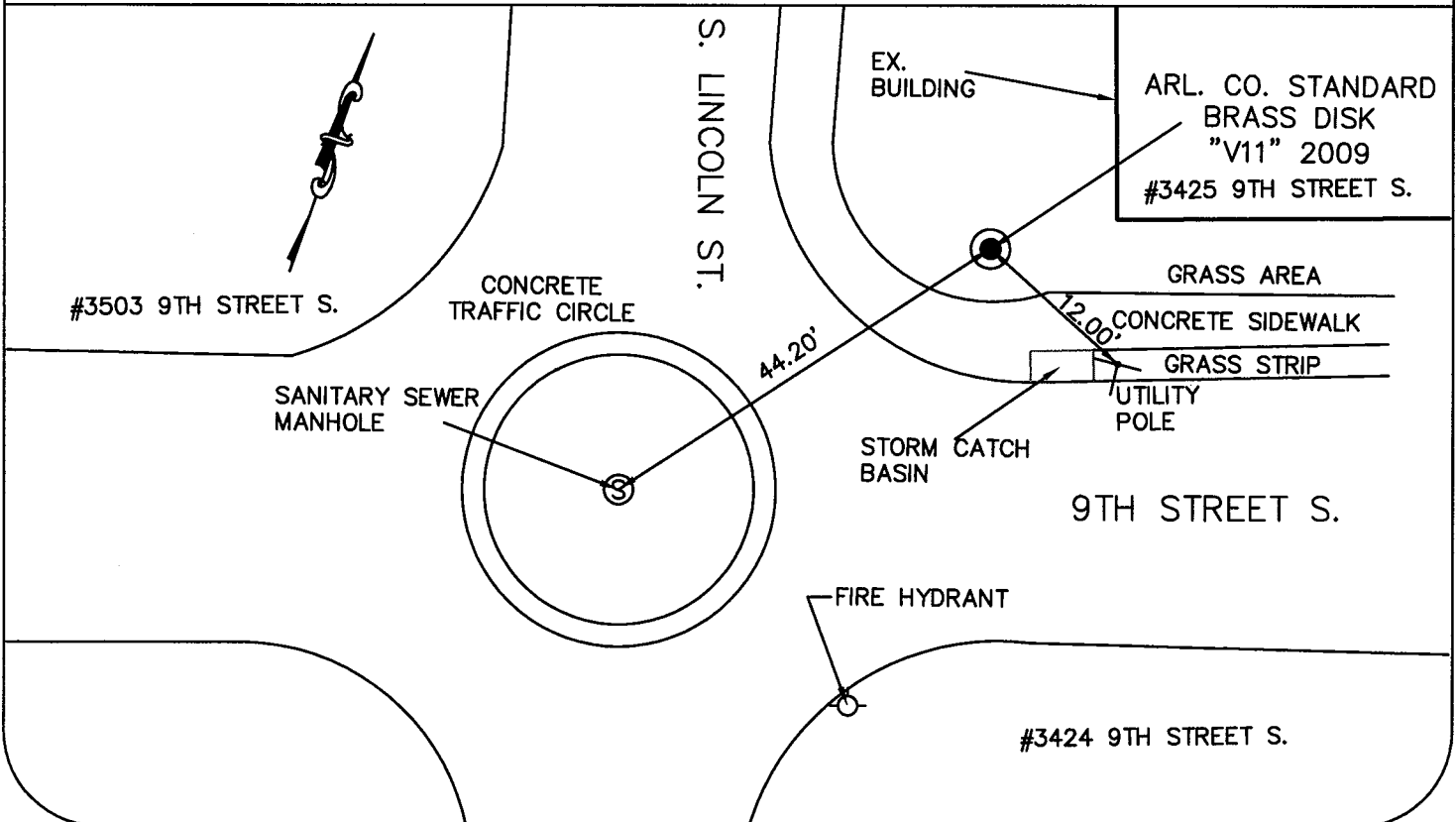



ARLINGTON COUNTY, VIRGINIA
 DEPARTMENT OF ENVIRONMENTAL SERVICES
 ENGINEERING AND CAPITAL PROJECTS DIVISION
 SURVEY SECTION

#1 COURTHOUSE PLAZA, SUITE 813
 2100 CLARENDON BOULEVARD
 ARLINGTON, VIRGINIA 22201
 (703) 228-3686 · FAX (703) 228-3606



GEODETTIC CONTROL SHEET

STATION ID #: CP-111	STATION NAME: V12
----------------------	-------------------

DATUM: NAD 83 (93)	MAP PROJECTION: Lambert	CONVERSION: US Survey Foot	YEAR: 2009
N: 7,000,637.585	E: 11,884,611.576	Lat: 38° 51' 48.907" N	Lon: 77° 05' 21.119" W
GRID FACTOR: 0.99999540	SCALE FACTOR: 0.99995758	COMBINED FACTOR: 0.99995298	
VERTICAL DATUM: NAVD 88	CONV. ANGLE: +00° 52' 49.8"		
ELEV. (FT): 201.24 ±2cm	VERT. ORDER: GPS	HORIZONTAL ORDER: SECOND	

TO REACH:

The point is located on the north side of 9th Street S. in the grass area at the intersection of 9th Street S. and S. Highlands St. The point is 26.10' from power pole #UG29, 13.10' from the corner of a concrete wall. The point is a standard Arlington County 3 1/2" brass disk set on a 600mm Berntsen Feno spike driven flush with the existing grade.

SKETCH: NOT TO SCALE

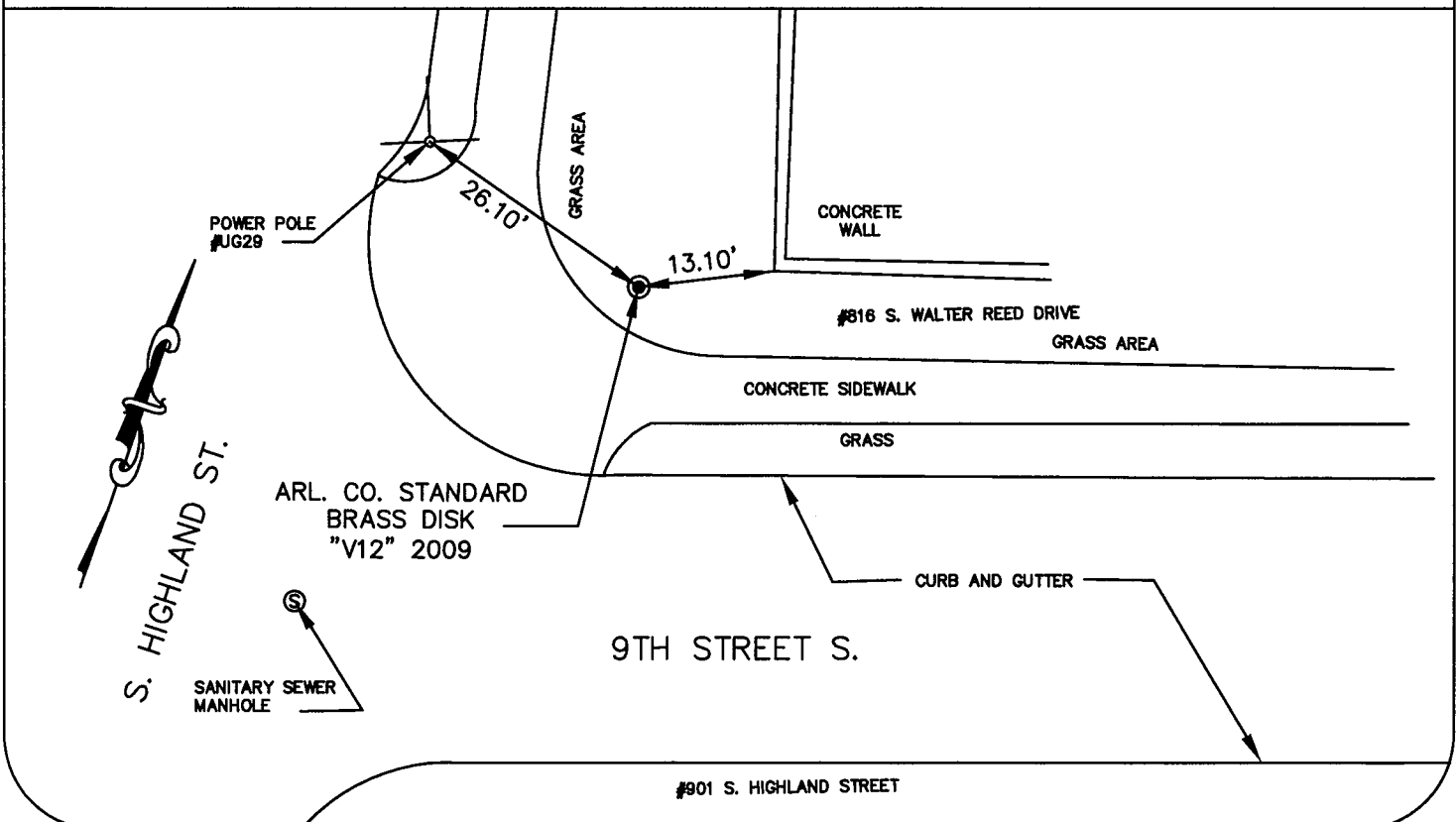



ARLINGTON COUNTY, VIRGINIA
 DEPARTMENT OF ENVIRONMENTAL SERVICES
 ENGINEERING AND CAPITAL PROJECTS DIVISION
 SURVEY SECTION

#1 COURTHOUSE PLAZA, SUITE 813
 2100 CLARENDON BOULEVARD
 ARLINGTON, VIRGINIA 22201
 (703) 228-3686 · FAX (703) 228-3606



GEODETTIC CONTROL SHEET

STATION ID #: CP-112		STATION NAME: V13	
DATUM: NAD 83 (93)	MAP PROJECTION: Lambert	CONVERSION: US Survey Foot	YEAR: 2009
N: 7,000,841.514	E: 11,885,249.920	Lat: 38° 51' 50.825" N	Lon: 77° 05' 13.010" W
GRID FACTOR: 0.99999585	SCALE FACTOR: 0.99995762	COMBINED FACTOR: 0.99995347	
VERTICAL DATUM: NAVD 88	CONV. ANGLE: +00° 52' 54.88"		
ELEV. (FT): 191.85 ±2cm	VERT. ORDER: GPS	HORIZONTAL ORDER: SECOND	

TO REACH:

The point is located in the grass area on the south side of 9th Street S., at the intersection of 9th Street S. and S. Walter Reed Drive. The point is located 16.50' from a vepco power pole on S. Walter Reed Drive and 31.10' from the tip of a grass island along 9th Street S.

The point is a standard Arlington County 3 1/2" brass disk set on a 600mm Berntsen Feno spike driven flush with the existing grade.

SKETCH: NOT TO SCALE

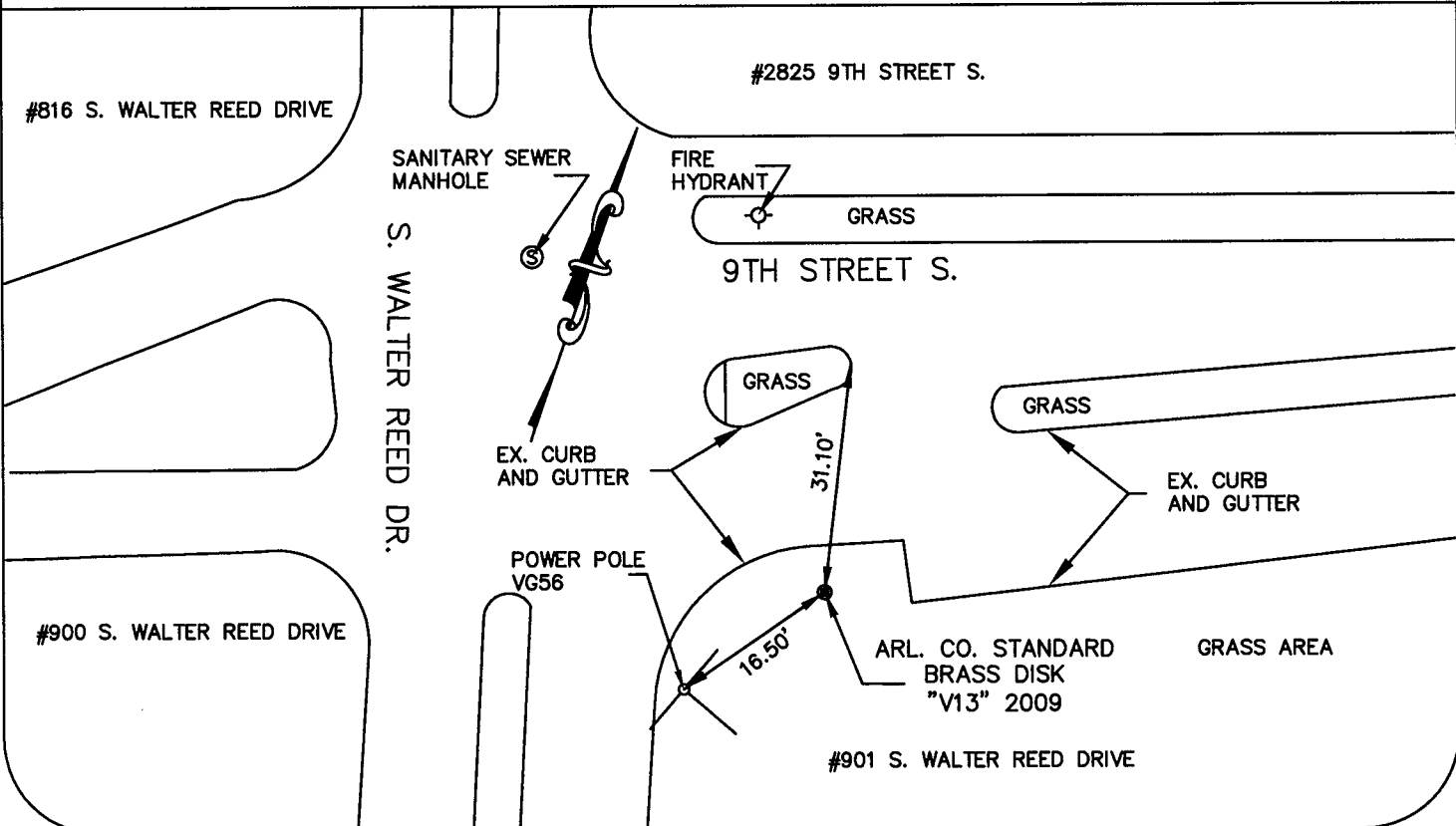



ARLINGTON COUNTY, VIRGINIA
 DEPARTMENT OF ENVIRONMENTAL SERVICES
 ENGINEERING AND CAPITAL PROJECTS DIVISION
 SURVEY SECTION

#1 COURTHOUSE PLAZA, SUITE 813
 2100 CLARENDON BOULEVARD
 ARLINGTON, VIRGINIA 22201
 (703) 228-3686 · FAX (703) 228-3606



GEODETTIC CONTROL SHEET

STATION ID #: CP-113		STATION NAME: V14	
DATUM: NAD 83 (93)	MAP PROJECTION: Lambert	CONVERSION: US Survey Foot	YEAR: 2009
N: 7,001,131.634	E: 11,886,542.152	Lat: 38° 51' 53.496" N	Lon: 77° 04' 56.617" W
GRID FACTOR: 0.99999526	SCALE FACTOR: 0.99995768	COMBINED FACTOR: 0.99995294	
VERTICAL DATUM: NAVD 88	CONV. ANGLE: +00° 53' 05.11"		
ELEV. (FT): 204.22 ±2cm	VERT. ORDER: GPS	HORIZONTAL ORDER: SECOND	

TO REACH:

The point is located in the grass strip on the East side of S. Wayne Street, at the intersection of 9th Street S. and S. Wayne Street. The point is located 12.60' from a water valve located on S. Wayne Street and 8.95' from the center of a water meter at house #903.

The point is a standard Arlington County 3 1/2" brass disk set on a 600mm Berntsen Feno spike driven flush with the existing grade.

SKETCH: NOT TO SCALE

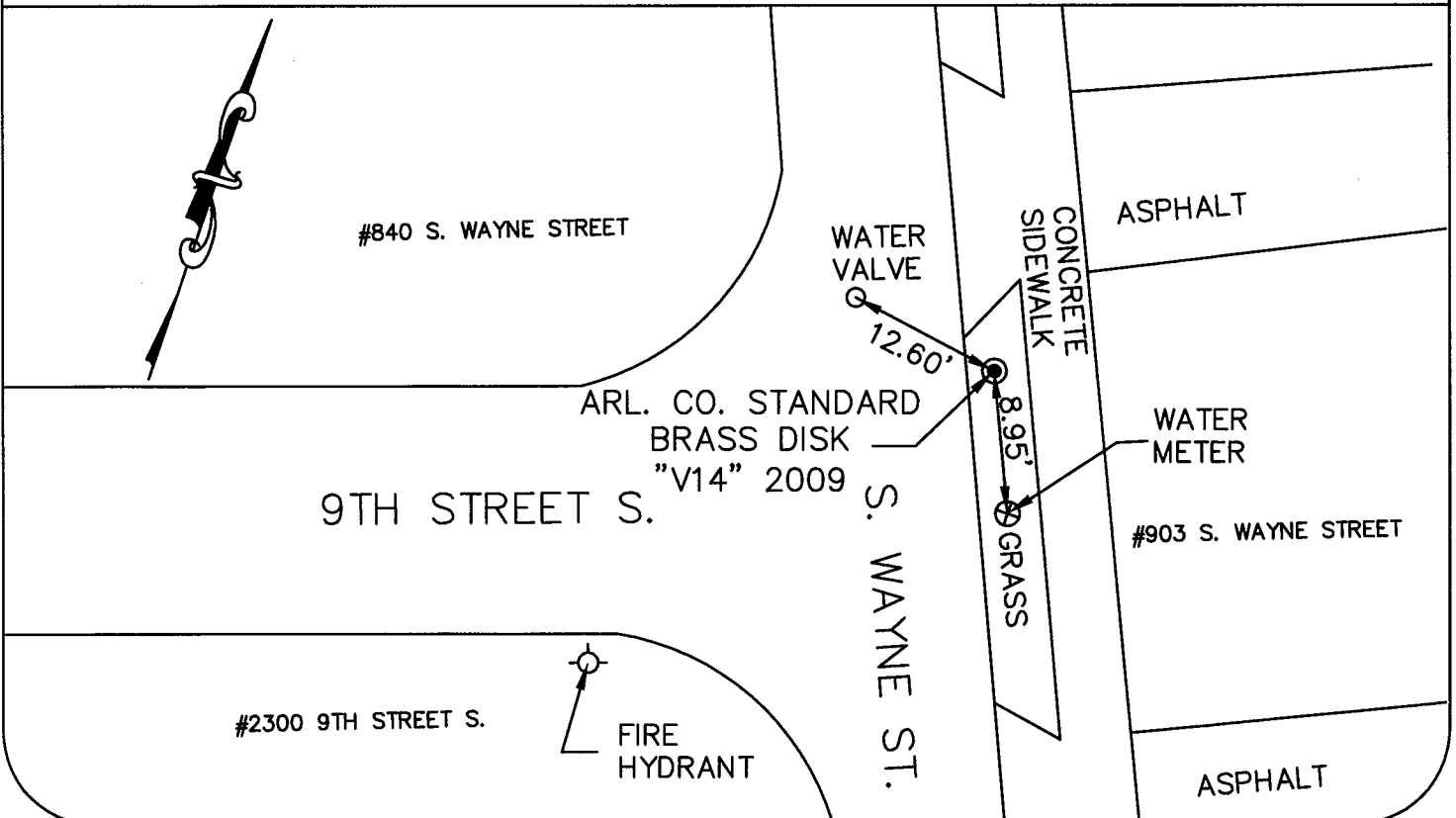



ARLINGTON COUNTY, VIRGINIA
 DEPARTMENT OF ENVIRONMENTAL SERVICES
 ENGINEERING AND CAPITAL PROJECTS DIVISION
 SURVEY SECTION

#1 COURTHOUSE PLAZA, SUITE 813
 2100 CLARENDON BOULEVARD
 ARLINGTON, VIRGINIA 22201
 (703) 228-3686 · FAX (703) 228-3606



GEODETTIC CONTROL SHEET

STATION ID #: CP-117		STATION NAME: V15	
DATUM: NAD 83 (93)	MAP PROJECTION: Lambert	CONVERSION: US Survey Foot	YEAR: 2009
N: 7,000,409.176	E: 11,887,188.149	Lat: 38° 51' 46.257" N	Lon: 77° 04' 48.592" W
GRID FACTOR: 0.99999576	SCALE FACTOR: 0.99995753	COMBINED FACTOR: 0.99995329	
VERTICAL DATUM: NAVD 88	CONV. ANGLE: +00° 53' 10.12"		
ELEV. (FT): 193.79 ±2cm	VERT. ORDER: GPS	HORIZONTAL ORDER: SECOND	

TO REACH:

The point is located in a grass strip, on the north side of 12th Street S., at the intersection of 12h Street S. and S. Courthouse Road. The point is located 16.70' from a 15" Oak tree and 34.90' from a water valve located on S. Courthouse Road.

The point is a standard Arlington County 3 1/2" brass disk set on a 600mm Berntsen Feno spike driven flush with the existing grade.

SKETCH: NOT TO SCALE

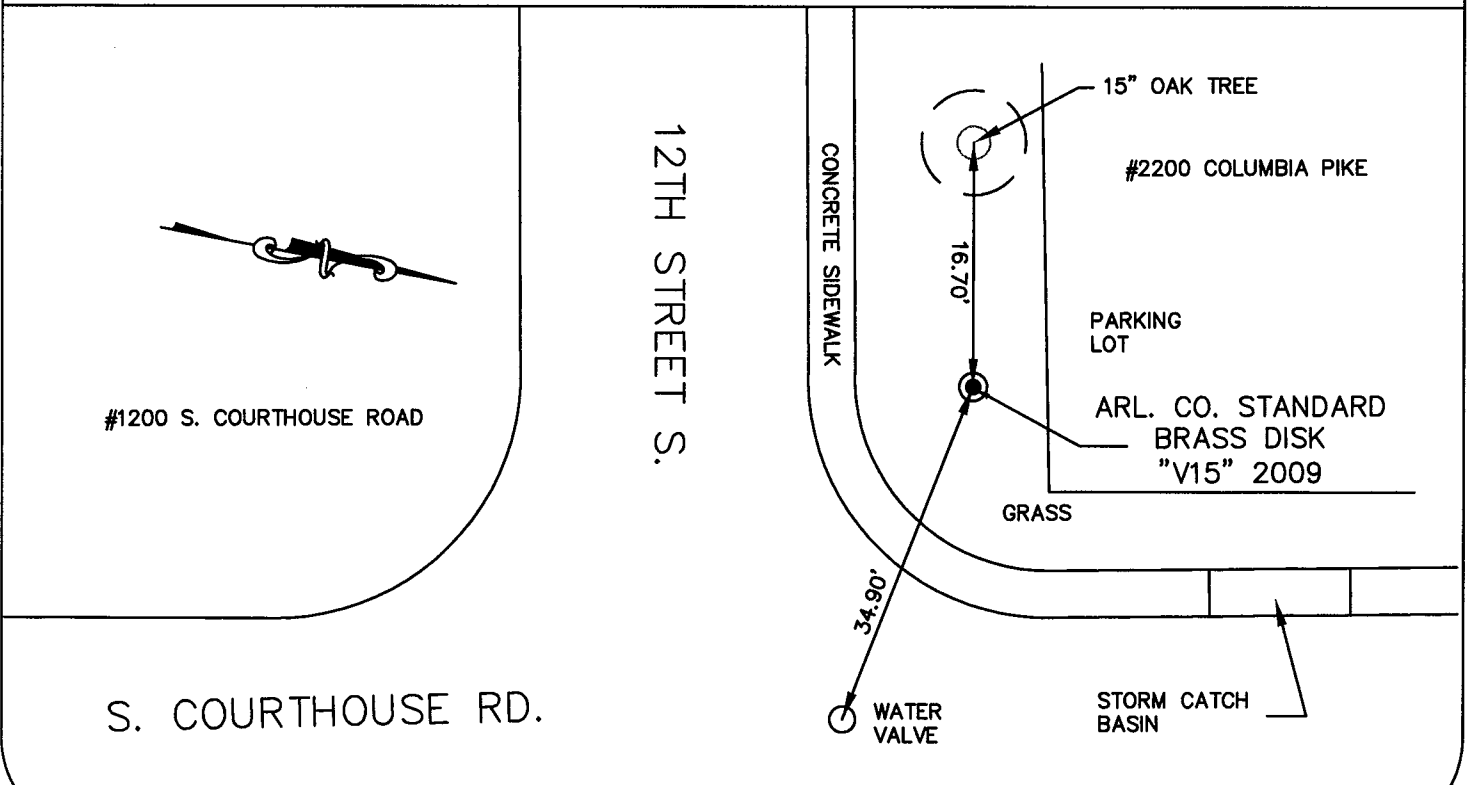



ARLINGTON COUNTY, VIRGINIA
 DEPARTMENT OF ENVIROMENTAL SERVICES
 ENGINEERING AND CAPITAL PROJECTS DIVISION
 SURVEY SECTION

#1 COURTHOUSE PLAZA, SUITE 813
 2100 CLARENDON BOULEVARD
 ARLINGTON, VIRGINIA 22201
 (703) 228-3686 · FAX (703) 228-3606

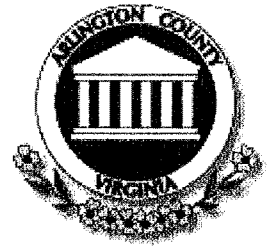

GEODETTIC CONTROL SHEET

STATION ID #: CP-116		STATION NAME: V16	
DATUM: NAD 83 (93)	MAP PROJECTION: Lambert	CONVERSION: US Survey Foot	YEAR: 2009
N: 7,000,509.752	E: 11,888,006.793	Lat: 38° 51' 47.125" N	Lon: 77° 04' 38.224" W
GRID FACTOR: 0.99999744	SCALE FACTOR: 0.99995755	COMBINED FACTOR: 0.99995498	
VERTICAL DATUM: NAVD 88	CONV. ANGLE: +00° 53' 16.59"		
ELEV. (FT): 158.68 ±2cm	VERT. ORDER: GPS	HORIZONTAL ORDER: SECOND	

TO REACH:

The point is located in a grass strip along the west side of S. Scott Street, at the corner of a asphalt parking lot. The point is 26.00' from the center of a sanitary sewer manhole at the intersection and 7.40' from the corner of a storm catch basin/parking lot corner.

The point is a standard Arlington County 3 1/2" brass disk set on a 600mm Berntsen Feno spike driven flush with the existing grade.

SKETCH: NOT TO SCALE

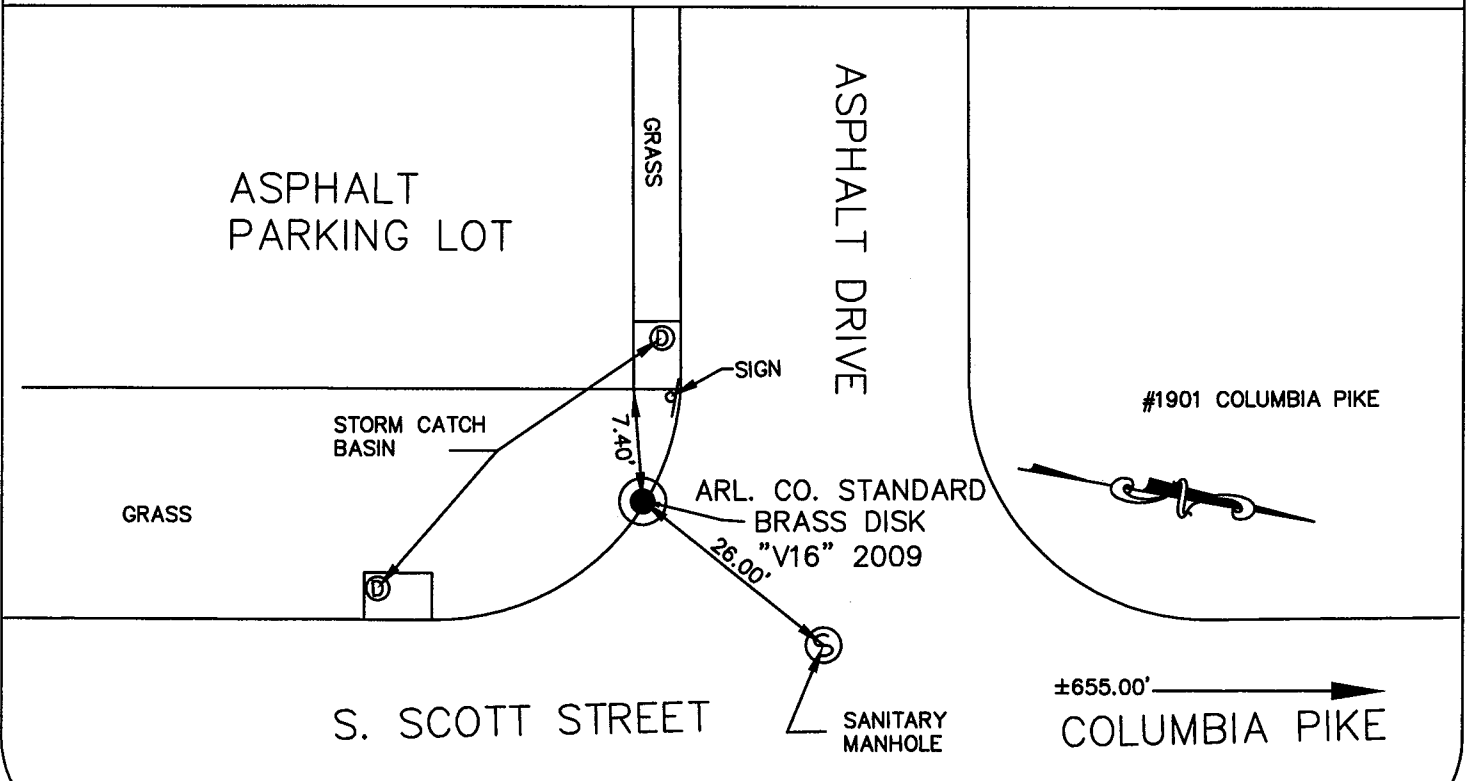

#1201 S. SCOTT STREET



ARLINGTON COUNTY, VIRGINIA
 DEPARTMENT OF ENVIROMENTAL SERVICES
 ENGINEERING AND CAPITAL PROJECTS DIVISION
 SURVEY SECTION

#1 COURTHOUSE PLAZA, SUITE 813
 2100 CLARENDON BOULEVARD
 ARLINGTON, VIRGINIA 22201
 (703) 228-3686 · FAX (703) 228-3606



GEODETTIC CONTROL SHEET

STATION ID #: CP-115		STATION NAME: V17	
DATUM: NAD 83 (93)	MAP PROJECTION: Lambert	CONVERSION: US Survey Foot	YEAR: 2009
N: 7,000,787.465	E: 11,888,930.978	Lat: 38° 51' 49.728" N	Lon: 77° 04' 26.486" W
GRID FACTOR: 0.99999775	SCALE FACTOR: 0.99995760	COMBINED FACTOR: 0.99995535	
VERTICAL DATUM: NAVD 88	CONV. ANGLE: +00° 53' 23.92"		
ELEV. (FT): 152.09 ±2cm	VERT. ORDER: GPS	HORIZONTAL ORDER: SECOND	

TO REACH:

The point is located in the grass area, on the north side of 12th Street S., at the intersection of 12th Street S. and S. Quinn Street. The point is located 19.00' from utility pole #E989 and 46.70' from the center of a water manhole. The point is a standard Arlington County 3 1/2" brass disk set on a 600mm Berntsen Feno spike driven flush with the existing grade.

SKETCH: NOT TO SCALE

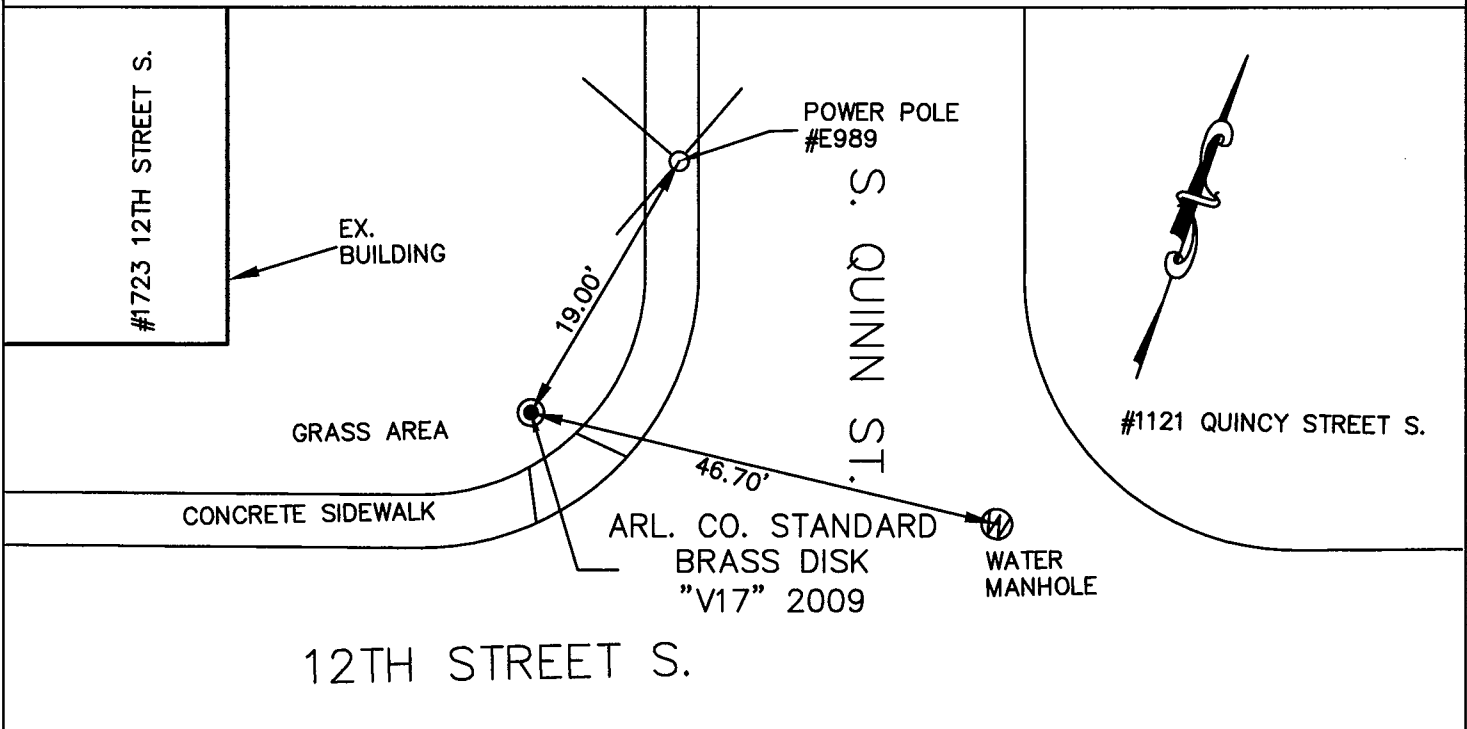



ARLINGTON COUNTY, VIRGINIA
 DEPARTMENT OF ENVIROMENTAL SERVICES
 ENGINEERING AND CAPITAL PROJECTS DIVISION
 SURVEY SECTION

#1 COURTHOUSE PLAZA, SUITE 813
 2100 CLARENDON BOULEVARD
 ARLINGTON, VIRGINIA 22201
 (703) 228-3686 · FAX (703) 228-3606



GEODETTIC CONTROL SHEET

STATION ID #: CP-114		STATION NAME: V18	
DATUM: NAD 83 (93)	MAP PROJECTION: Lambert	CONVERSION: US Survey Foot	YEAR: 2009
N: 7,000,825.598	E: 11,889,770.509	Lat: 38° 51' 49.976" N	Lon: 77° 04' 15.865" W
GRID FACTOR: 0.99999766	SCALE FACTOR: 0.99995761	COMBINED FACTOR: 0.99995527	
VERTICAL DATUM: NAVD 88	CONV. ANGLE: +00° 53' 30.55"		
ELEV. (FT): 154.04 ±2cm	VERT. ORDER: GPS	HORIZONTAL ORDER: SECOND	

TO REACH:

The point is located in the grass area, on the south side of 12th Street S., near the intersection of 12th Street S. and S. Pierce Street. The point is located 5.00' from the center of a fire hydrant on 12th Street S. and 40.90' from the northeast corner of house #1552 12th Street S.

The point is a standard Arlington County 3 1/2" brass disk set on a 600mm Berntsen Feno spike driven flush with the existing grade.

SKETCH: NOT TO SCALE

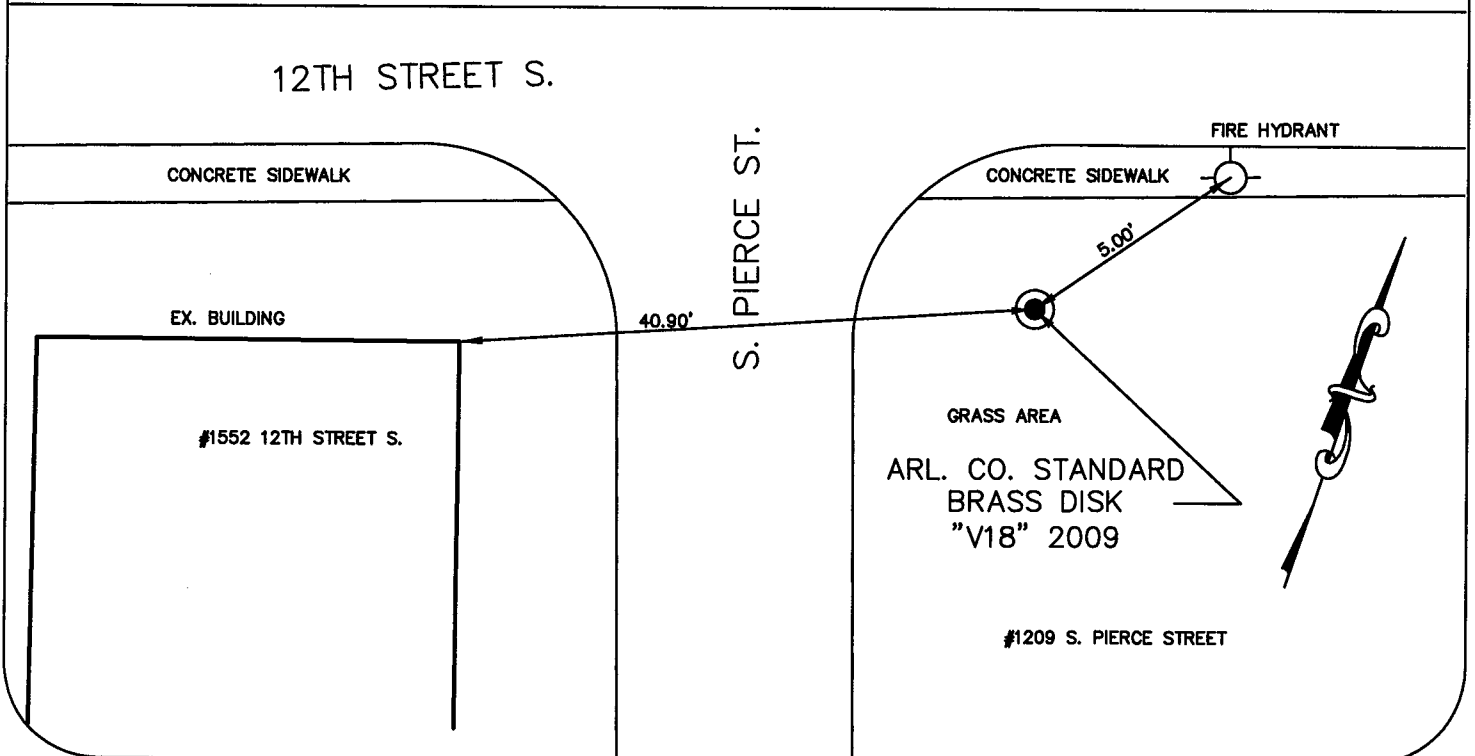



ARLINGTON COUNTY, VIRGINIA
 DEPARTMENT OF ENVIRONMENTAL SERVICES
 ENGINEERING AND CAPITAL PROJECTS DIVISION
 SURVEY SECTION

#1 COURTHOUSE PLAZA, SUITE 813
 2100 CLARENDON BOULEVARD
 ARLINGTON, VIRGINIA 22201
 (703) 228-3686 · FAX (703) 228-3606



GEODETTIC CONTROL SHEET

STATION ID #: CP-118	STATION NAME: V19
----------------------	-------------------

DATUM: NAD 83 (93)	MAP PROJECTION: Lambert	CONVERSION: US Survey Foot	YEAR: 2009
N: 6,996,390.007	E: 11,877,414.195	Lat: 38° 51' 08.009" N	Lon: 77° 06' 52.917" W
GRID FACTOR: 0.99999487	SCALE FACTOR: 0.99995676	COMBINED FACTOR: 0.99995162	
VERTICAL DATUM: NAVD 88	CONV. ANGLE: +00° 51' 52.3"		
ELEV. (FT): 212.24 ±2cm	VERT. ORDER: GPS	HORIZONTAL ORDER: SECOND	

TO REACH:

The point is located in the grass area at the intersection of 10th Place S. and S. Frederick Street. The point is located 15.70' from a gas valve on 10th Place S. and 17.00' from a light pole on S. Frederick Street. The point is a standard Arlington County 3 1/2" brass disk set on a 600mm Brentsen Feno spike driven flush with the existing grade.

SKETCH: NOT TO SCALE

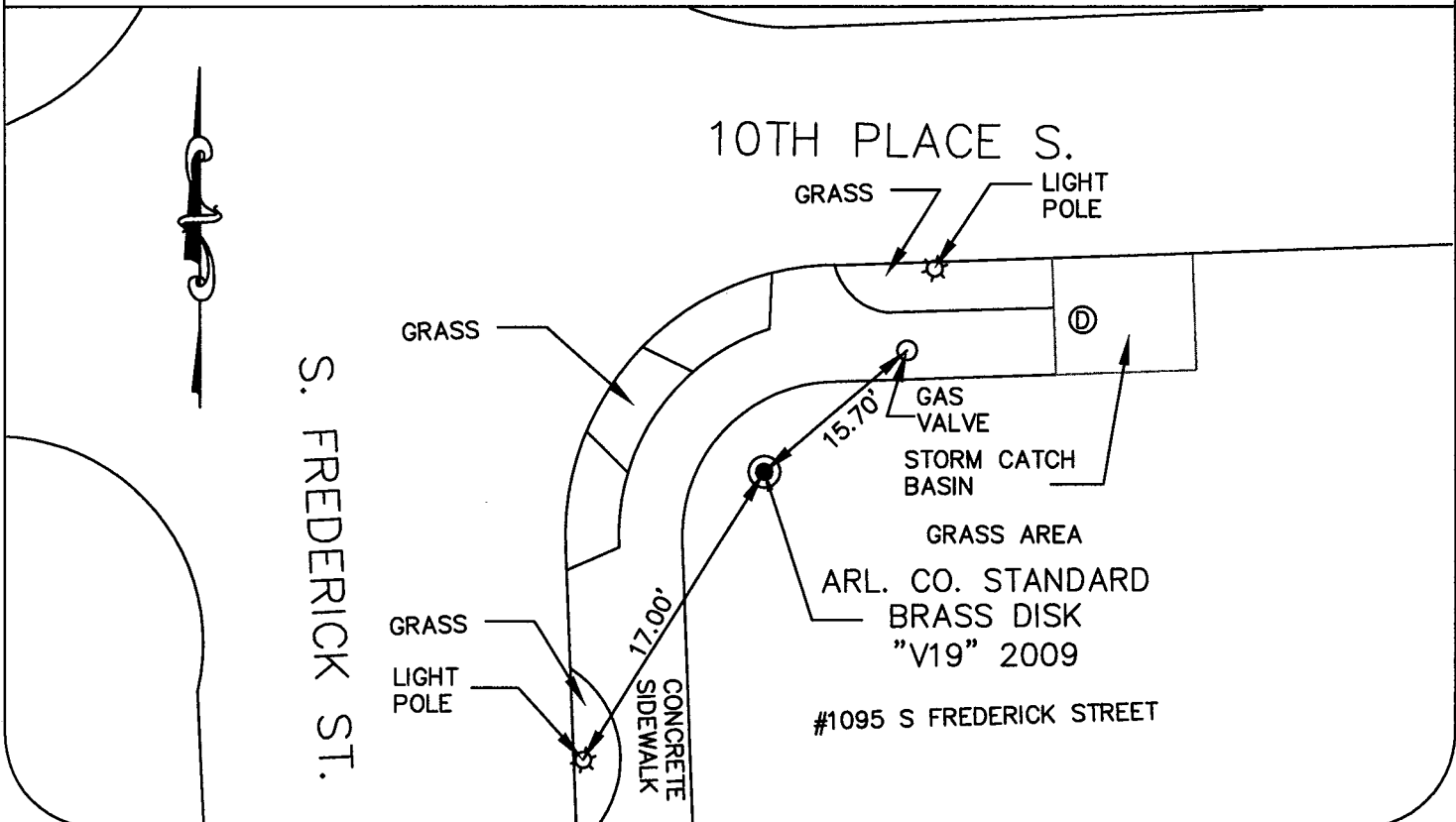



ARLINGTON COUNTY, VIRGINIA
 DEPARTMENT OF ENVIRONMENTAL SERVICES
 ENGINEERING AND CAPITAL PROJECTS DIVISION
 SURVEY SECTION

#1 COURTHOUSE PLAZA, SUITE 813
 2100 CLARENDON BOULEVARD
 ARLINGTON, VIRGINIA 22201
 (703) 228-3686 · FAX (703) 228-3606



GEODETTIC CONTROL SHEET

STATION ID #: CP-119

STATION NAME: V20

DATUM: NAD 83 (2007)	MAP PROJECTION: Lambert	CONVERSION: US Survey Foot	YEAR: 2009
N: 6,996,356.431	E: 11,876,978.094	Lat: 38° 51' 07.742" N	Lon: 77° 06' 58.435" W
GRID FACTOR: 0.99999341	SCALE FACTOR: 0.99995675	COMBINED FACTOR: 0.99995016	
VERTICAL DATUM: NAVD 88	CONV. ANGLE: +00° 51' 49.08"		
ELEV. (FT): 242.68 ±2cm	VERT. ORDER: GPS	HORIZONTAL ORDER: SECOND	

TO REACH:

The point is located in the grass strip along the north side of 10th Place S. The point is located 9.60' from a water meter for house #5223 and 8.30 from the corner of a brick column for #5223 with a mailbox installed.
 The point is a standard Arlington County 3 1/2" brass disk set on a 600mm Brentsen Feno spike driven flush with the existing grade.

SKETCH: NOT TO SCALE

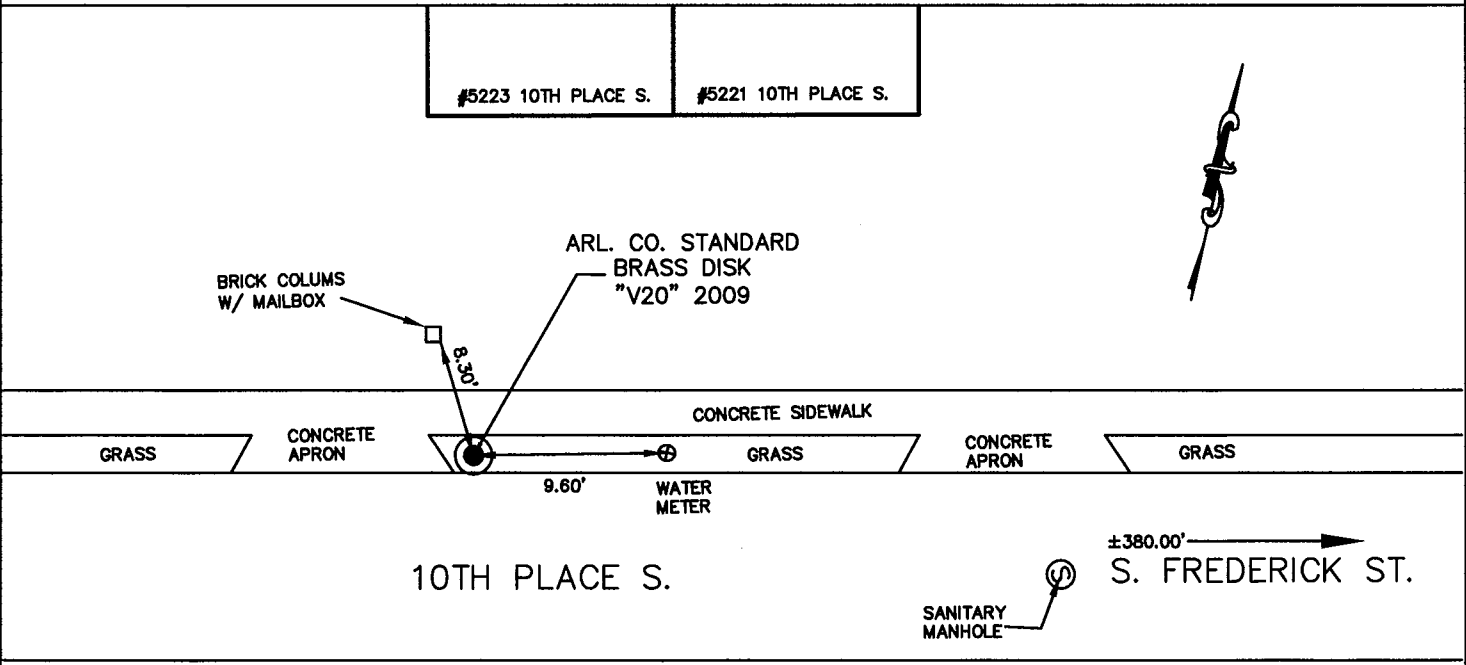

#5222 10TH PLACE S.