

# ARLINGTON COUNTY, VIRGINIA

DEPARTMENT OF PUBLIC WORKS

ENGINEERING DIVISION

SURVEY SECTION

#1 COURTHOUSE PLAZA, SUITE 813

2100 CLARENDON BOULEVARD

ARLINGTON, VIRGINIA 22201

(703) 228-3686 · FAX (703) 228-3606

<i>GEODETIC CONTROL SHEET</i>			<i>STATE PLANE: VA STATE GRID NORTH</i>
<i>Arlington County Control</i>			<i>DATUM: NAD 83 (93)</i>
<i>COUNTY</i>	<i>NAME OF STATION</i>	<i>YEAR</i>	<i>MAP PROJECTION: Lambert</i>
<i>Arlington</i>	<i>42</i>	<i>2000</i>	<i>CONVERSION: US Survey Foot</i>
<i>N: 6993702.1419</i>	<i>E: 11885726.0861</i>	<i>Lat: 38° 50' 40.19039"N</i>	<i>Lon: 077° 05' 08.38111"W</i>
<i>SCALE FACTOR: 0.99995621</i>	<i>ELEV. FACTOR: 0.99999735</i>	<i>CONV. ANGLE: 00° 52' 57.770"</i>	<i>DATE: DECEMBER 5, 2000</i>
<i>VERTICAL DATUM: NAVD 88</i>	<i>COMBINED FACTOR: 0.999953566</i>		<i>HORIZONTAL ORDER: SECOND*</i>
<i>ELEV. (FT): 55.3'</i>			
<i>VERT. ORDER: GPS</i>			

**TO REACH:**

*The station is a standard Arlington County brass disk set in concrete and is located in the northwest quadrant of the intersection of Shirlington Road and Four Mile Run Drive. See sketch for a more detailed location.*

**SKETCH: NOT TO SCALE**

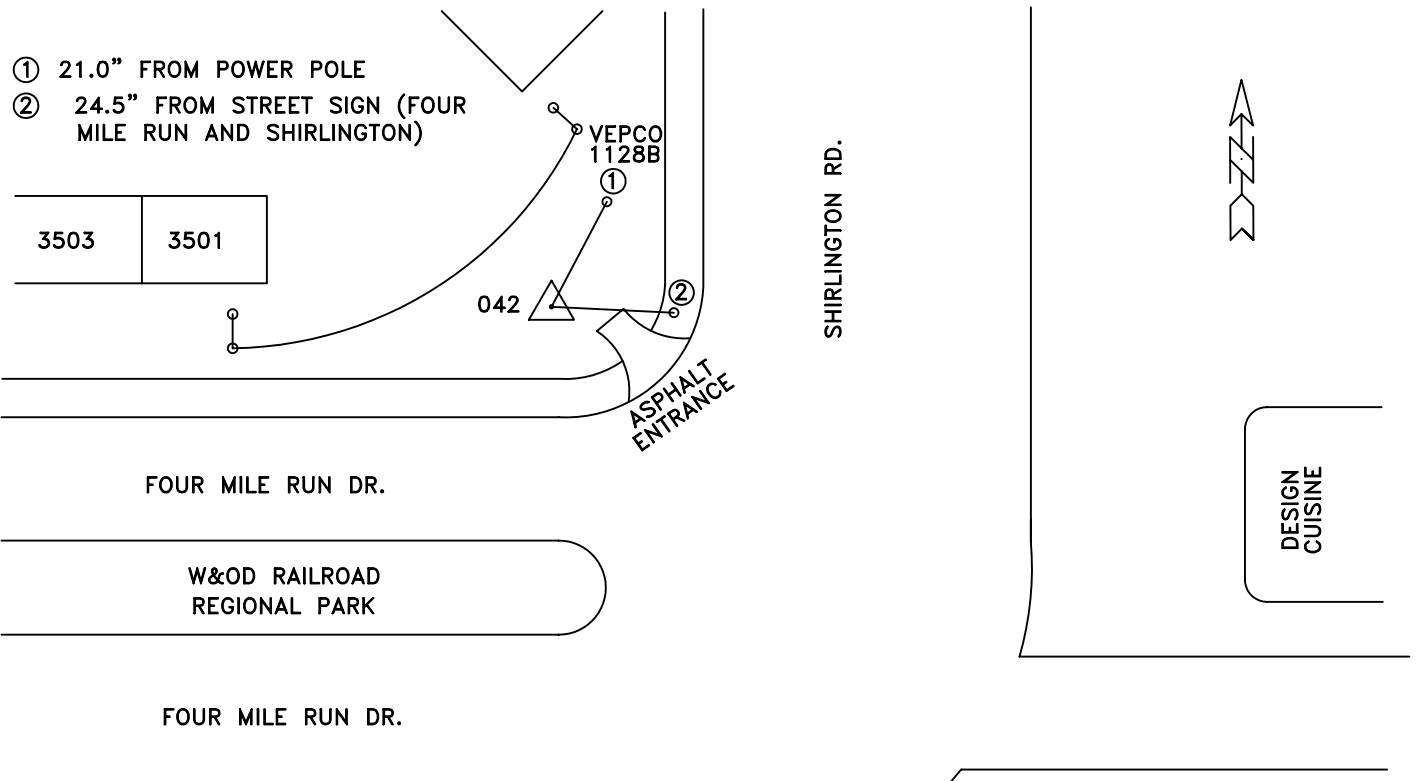

\* HORIZONTAL ORDER DOES NOT DENOTE CONFORMANCE TO ALL FGCS/NGS STANDARDS OR SPECIFICATIONS