

ARLINGTON COUNTY, VIRGINIA

DEPARTMENT OF PUBLIC WORKS

ENGINEERING DIVISION

SURVEY SECTION

#1 COURTHOUSE PLAZA, SUITE 813
2100 CLARENDON BOULEVARD
ARLINGTON, VIRGINIA 22201
(703) 228-3686 · FAX (703) 228-3606

<i>GEODETTIC CONTROL SHEET</i>			<i>STATE PLANE: VA STATE GRID NORTH</i>
<i>Arlington County Control</i>			<i>DATUM: NAD 83 (93)</i>
<i>COUNTY</i>	<i>NAME OF STATION</i>	<i>YEAR</i>	<i>MAP PROJECTION: Lambert</i>
<i>Arlington</i>	<i>24</i>	<i>1999</i>	<i>CONVERSION: US Survey Foot</i>
<i>N: 6994429.9408</i>	<i>E: 11886326.2878</i>	<i>Lat: 38° 50' 47.292173"N</i>	<i>Lon: 77° 05' 00.653670"W</i>
<i>SCALE FACTOR: 0.99995635</i>	<i>ELEV. FACTOR: 0.99999621</i>	<i>CONV. ANGLE: 00° 53' 02.593143"</i>	<i>DATE: May 18, 1999</i>
<i>VERTICAL DATUM: NAVD 88</i>	<i>COMBINED PROJECT FACTOR: 0.999952560</i>		<i>HORIZONTAL ORDER: First</i>
<i>ELEV. (FT): 79.2</i>			
<i>VERT. ORDER: GPS</i>			

TO REACH:

Point is located in the grass strip in front of an auto repair shop (Shirlington Auto Service) at #2515 South Shirlington Road south of the driveway entrance. The point, being a standard Arlington County brass disk set in concrete, lies 18.5 feet South of the point of curvature of the driveway curb, 1.9 feet East of the face of curb and 10.4 feet North from a street sign.

SKETCH: NOT TO SCALE

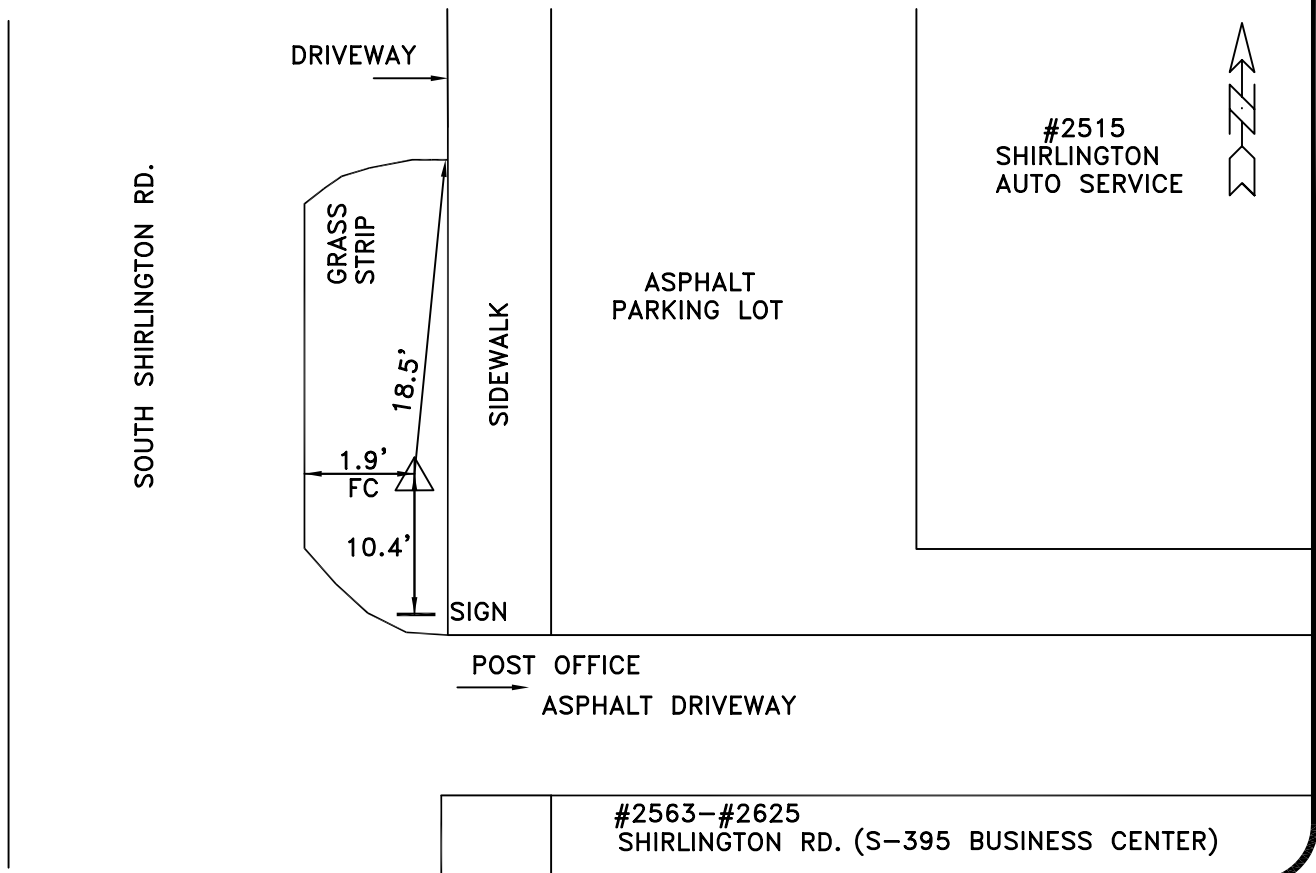

#2563-#2625
SHIRLINGTON RD. (S-395 BUSINESS CENTER)